

MF 86

Modular Ice Machine up to 2400 kg

Item #:
Project:
Quantity:



FEATURES

- Semi-hermetic compressor.
- Choice of air, water or remote air-cooled condensers.
- Stainless steel auger and freezing cylinder (evaporator).
- Equipped with an electromechanical control panel.
- Ice breaker made in specially strengthened alloy, allowing for greater extrusion pressure to deliver a dryer quality of ice (85% dry).
- Long-lasting stainless steel ball-bearings.
- Current protection on gear motor and safety coupling between gear box and auger.



MF 86
Flake ice
Residual water content 25%

CONDENSING SYSTEM

Air cooled
Remote condenser
Water cooled

REFRIGERANT GAS

R404A

VOLTAGE V/Hz/ph

230/50/3
230/60/3
380/60/3N
400/50/3N

RECOMMENDED BINS

Head	Bins		kg
MF 86	●	UBH2250	1068
	●	SIS1350	613 + 73 + 73

LEGENDA:

- ✓ : Perfect combination between ice maker and bin
- : Ice chute cut-out performed upon installation
- CBTxxxxxxxx : need additional bin top

Certifications:



OPERATING REQUIREMENTS

	Minimum	Maximum
Air temperature	10°C	43°C
Water temperature	5°C	38°C
Water pressure	1 bar (14 psi)	5 bar (70 psi)
Electrical voltage	-10%	+10%

IMPORTANT NOTICE:
Models and specifications are subject to change without notice. This spec sheet is meant for commercial purpose only. For technical documentation please refer to our service manuals.

Download our free **App Scotsman Ice**
Apple store
Google play
Windows store



www.scotsman-ice.it
www.scotsman-ice.com

Modular Ice Machine up to 2400 kg

MF 86

Modular Ice Machine up to 2400 kg

Item #:
Project:
Quantity:

Modular Ice Machine up to 2400 kg

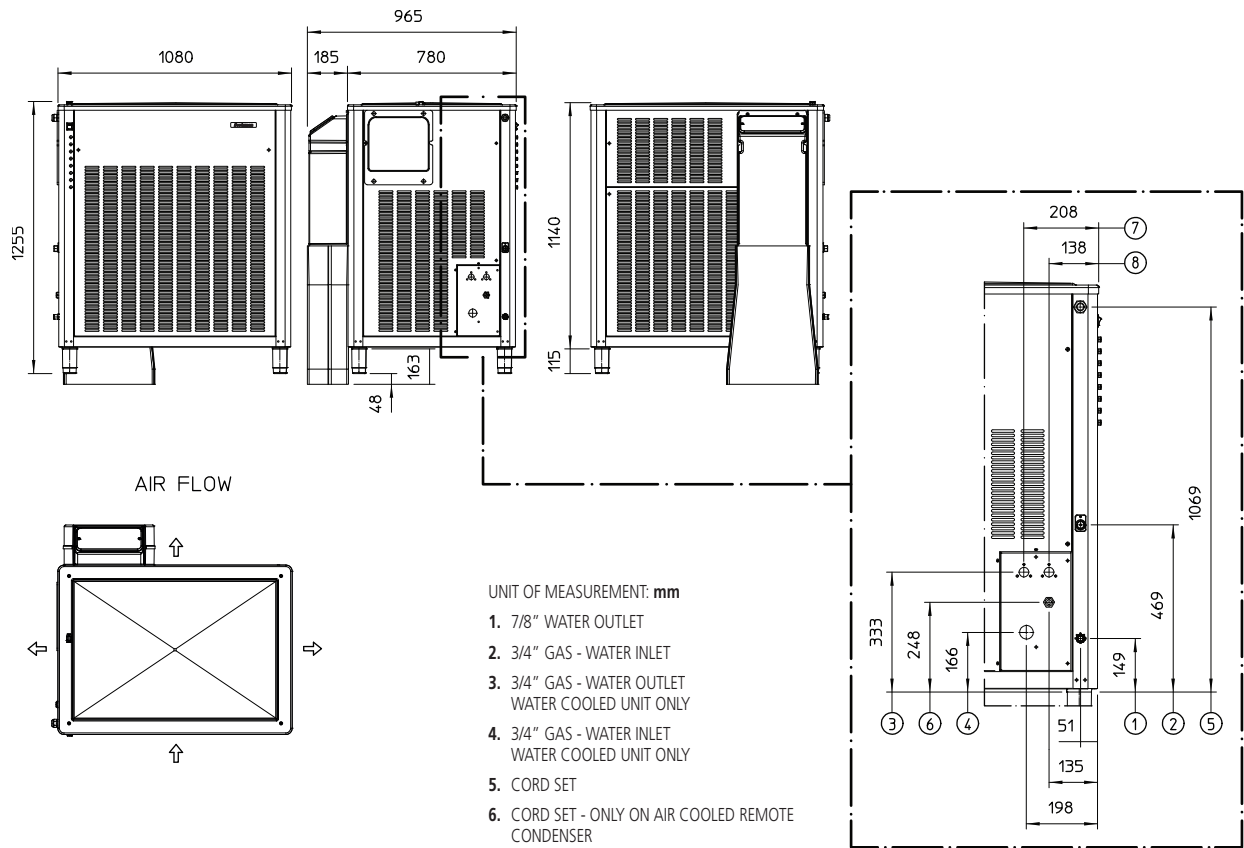

UNIT DATA		Compressor		Circuit wires		Max. fuse size		
		Version	Voltage	Btu/h	W	No.	Ømm ²	A
Size (W x D x H)	1080 x 780 x 1255 mm	MF 86 AS	230/50/3	34121	10000	4	4.0	32
Net weight	390 kg	MF 86 AS	400/50/3N	34121	10000	5	4.0	25
SHIPPING DATA		MF 86 WS	400/50/3N	34121	10000	5	4.0	32
		MF 86 AS	230/60/3	22964	6730	4	6.0	32
Carton (W x D x H)	1170 x 920 x 1340 mm	MF 86 AS	380/60/3N	22964	6730	5	4.0	25
Weight	411 kg	MF 86 ASR	380/60/3N	22964	6730	5	6.0	32

Version	Condensation	Voltage	24 h ice production kg °C Amb. / °C Water			Energy consumption*		Water usage* l/h	Instant power W
			10°C/10°C	21°C/10°C	32°C/21°C	kWh/100 kg	kWh/24h		
MF 86 AS	Air	230/50/3	2400	2400	1850	7.4	138.5	77.1	6100
MF 86 AS	Air	400/50/3N	2400	2400	1850	7.4	138.5	77.1	6100
MF 86 WS	Water	400/50/3N	2400	2400	1850	7.4	138.5	416.7	5800
MF 86 AS	Air	230/60/3	2400	2400	1850	8.1	149.6	77.1	6280
MF 86 AS	Air	380/60/3N	2400	2400	1850	8.1	149.6	77.1	6280
MF 86 ASR	Remote	380/60/3N	2400	2400	1850	8.1	149.6	77.1	6280

(*) Data refer to 32°C Amb. / 21°C Water temperature conditions