

XTR Brake Lever

BL-M9200 For Disc Brake

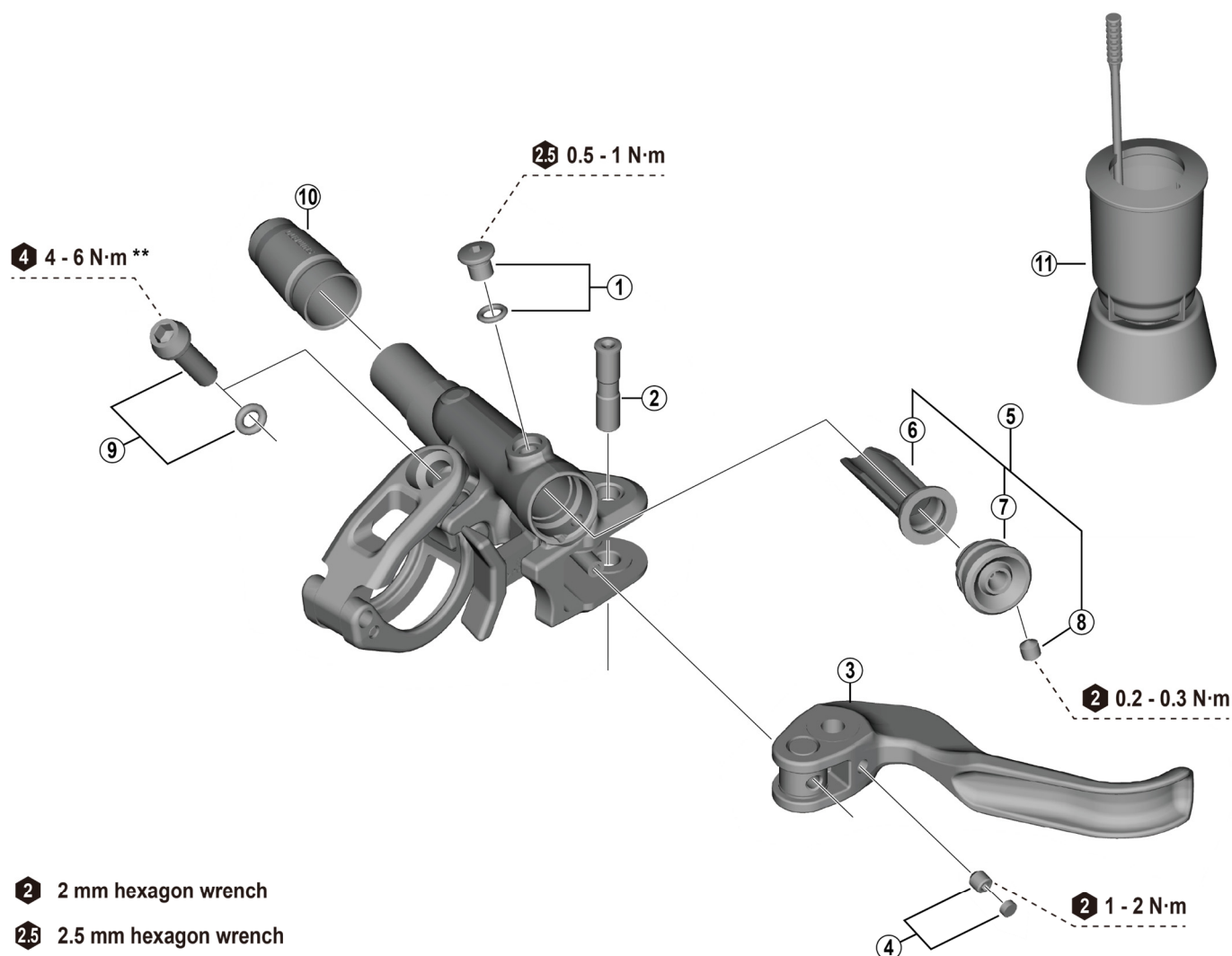

- 2** 2 mm hexagon wrench
- 2.5** 2.5 mm hexagon wrench
- 4** 4 mm hexagon wrench

**** When installing parts onto a carbon frame/handlebar, confirm the recommended tightening torque with the carbon frame or handlebar manufacturer.**
This will prevent damage to the frame/handlebar due to over-torquing or inadequate securing of the components.

ITEM NO.	SHIMANO CODE NO.	DESCRIPTION	INTERCHANGEABILITY		
			BL-M9100	BL-M9200	
1	Y8WC98010	Bleed screw and O-ring	A		
2	Y1XJ07000	Lever axle	A		
3	Y1XJ98010	Lever blade unit	A		
4	Y8V398040	Lever axle fixing screw and cap	A		
5	Y1XJ98030	Diaphragm unit	A		
6	Y8WM9801T	Diaphragm	A		
7	Y1XJ9801T	Cap	A		
8	Y8SZ07000	Cap fixing screw	A		
9	Y1XJ98020	Mounting screw (M5 x17) and O-ring	A		
10	Y1XJ16000	Cover	A		
11	Y13000100	TL-BR003 Funnel unit for M5 screw	A	A	

A: Same parts.

B: Parts are usable, but differ in materials, appearance, finish, size, etc.

Absence of mark indicates non-interchangeability.

Specifications are subject to change without notice.

Torque information is listed.

Jun.-2025-5074

© Shimano Inc. I

SHIMANO



quefairedemesdechets.fr