

# GRX Brake Lever

## BL-RX825-L For Disc Brake

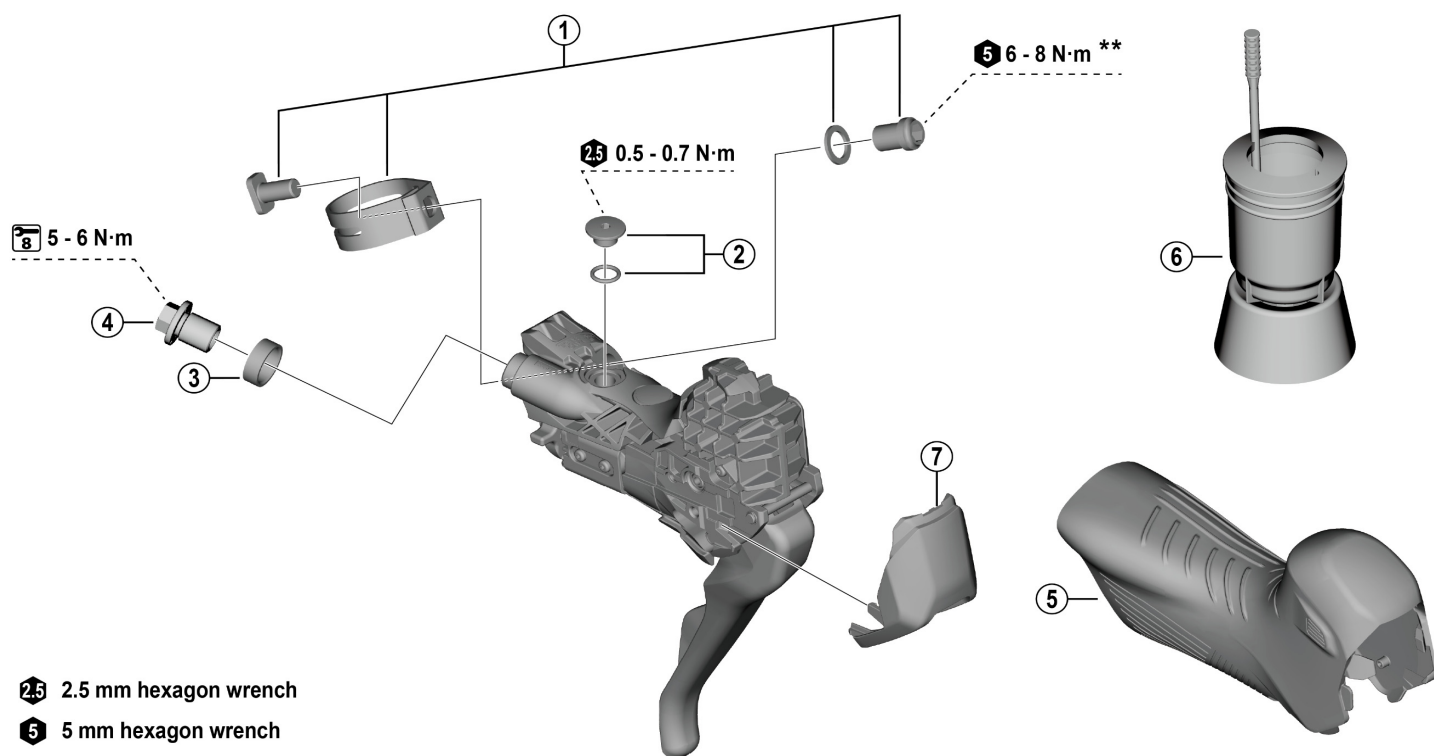

2.5 2.5 mm hexagon wrench

5 5 mm hexagon wrench

8 8 mm spanner

**\*\* When installing parts onto a carbon frame/handlebar, confirm the recommended tightening torque with the carbon frame or handlebar manufacturer.**  
This will prevent damage to the frame/handlebar due to over-torquing or inadequate securing of the components.

ITEM NO.	SHIMANO CODE NO.	DESCRIPTION	ST-RX825 ST-RX815		
			INTERCHANGEABILITY		
1	Y0SL98030	Clamp band unit diameter (23.8 - 24.2 mm)	A		
2	Y0F398030	Bleed screw and O-ring	A	A	
3	Y0RM9801T	Joint support ring	A	B	
4	Y8RD02000	Flange flare nut (M9/black)	A	A	
5	Y0SL98020	Bracket covers (pair)	A		
6	Y13000090	TL-BR002 Funnel unit for M7 screw			
7	Y2M79801T	Front cover L			

A: Same parts.

B: Parts are usable, but differ in materials, appearance, finish, size, etc.

Absence of mark indicates non-interchangeability.

Specifications are subject to change without notice.

Torque information is listed.

Jun.-2025-5094

© Shimano Inc. I

# SHIMANO

