

XTR Front Wheel
WH-M9220-TL-F15-B-29

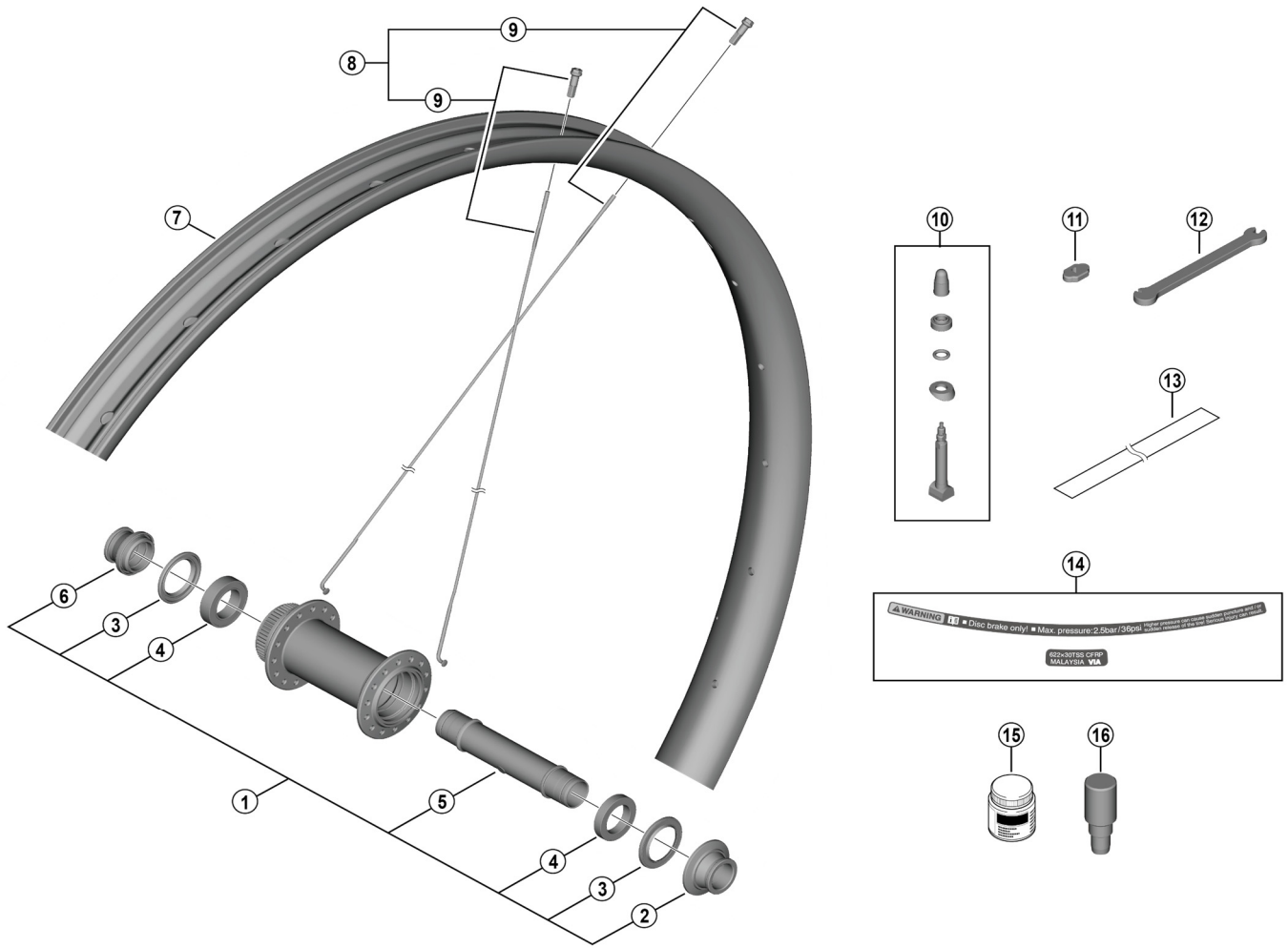

• O.L.D. 110 mm

ITEM NO.	SHIMANO CODE NO.	DESCRIPTION	INTERCHANGE-ABILITY		
1	Y2LF98010	Complete hub axle		A	
2	Y2LF98020	Right cap	A	A	
3	Y27X14000	Seal ring	A	A	
4	Y3KG9802T	Sealed cartridge bearing (17 x 30 x 7 / CN)		A	
5	Y2LF98030	Hub axle		A	
6	Y2LF98040	Left cap	A	A	
7	-	Rim {28H}			
8	-	Spoke unit {spoke (299 mm x 28 pcs.) / nipple (28 pcs.)}			
9	Y0TZ98010	Spoke (299 mm/1 pc.) and nipple (1 pc.)			
10	Y0TW98040	Valve unit	A		
11	Y4RJ10000	Valve tool	A		
12	Y0MK14000	TL-WHR92 Nipple wrench 3.4	A		
13	Y0TW9802T	Tubeless tape	A		
14	Y0TZ98020	Rim sticker unit			
15	Y38Z98000	Seal grease for freehub (50 g)	A	A	
16	Y2LF9802T	TL-HB017 Hub bearing remover	A	A	

A: Same parts.

B: Parts are usable, but differ in materials, appearance, finish, size, etc.

Absence of mark indicates non-interchangeability.

Specifications are subject to change without notice.

Torque information is listed.

Jun.-2025-5124

© Shimano Inc. I

SHIMANO

