

XTR Crankset

FC-M9220

SM-CRM96

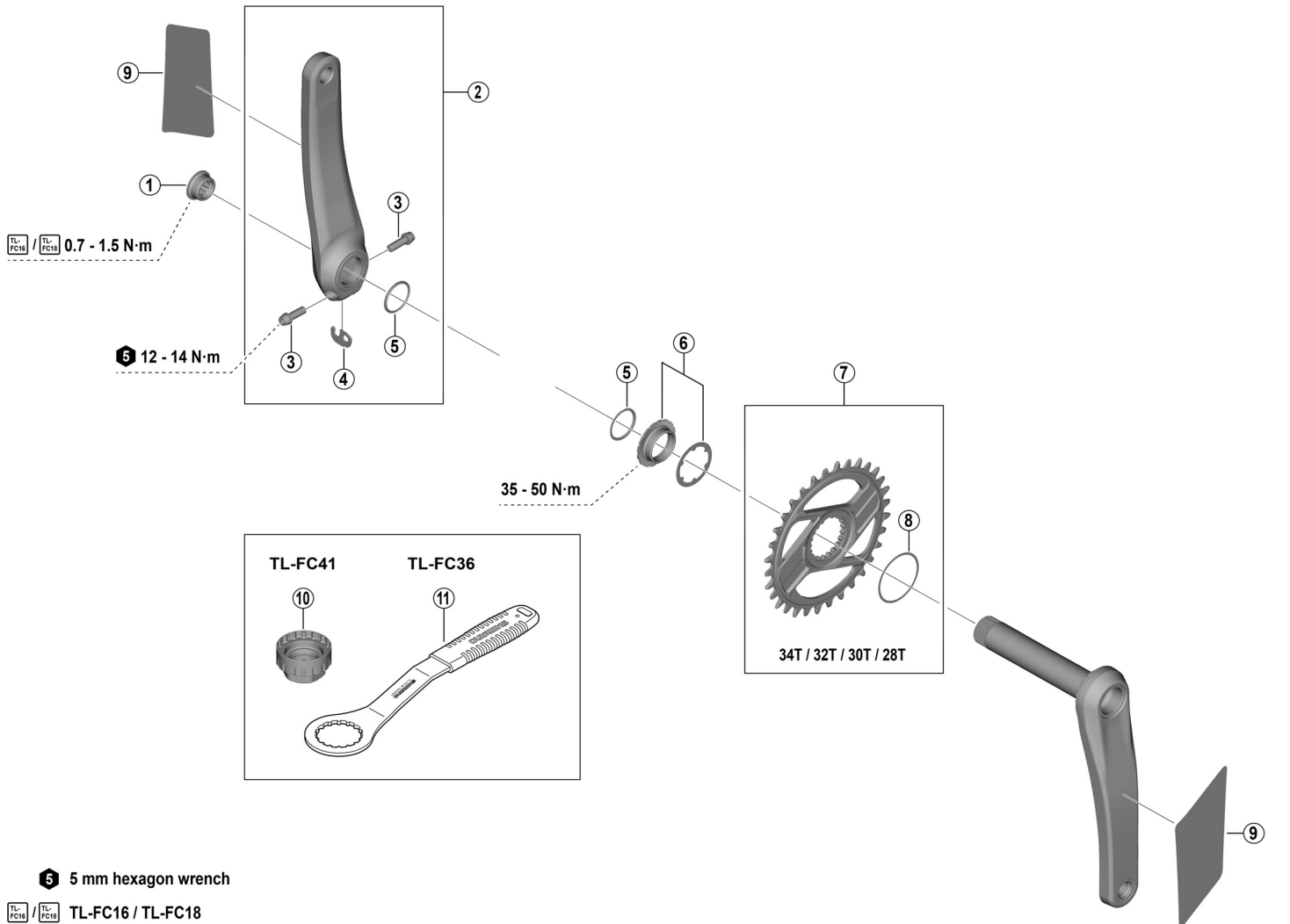

• Chaining teeth specification: 34T / 32T / 30T / 28T

ITEM NO.	SHIMANO CODE NO.	DESCRIPTION	INTERCHANGEABILITY				
1	Y1LR13000	Crank mounting screw	A				
2	Y0XA98010	Left-hand crank arm unit 160 mm with protection sticker					
	Y0XA98020	Left-hand crank arm unit 165 mm with protection sticker					
	Y0XA98030	Left-hand crank arm unit 170 mm with protection sticker					
	Y0XA98040	Left-hand crank arm unit 175 mm with protection sticker					
3	Y1GS22100	Crank fixing screw with washer (M6 x 19)	A				
4	Y0J698050	Plate	A				
5	Y1F316000	Ring	A	A	A	A	A
6	Y0X998050	Lock ring and washer	A				
7	ISMCRM96AZ8	Chaining 28T with spacer (SM-CRM96)	A				
	ISMCRM96AA0	Chaining 30T with spacer (SM-CRM96)	A				
	ISMCRM96AA2	Chaining 32T with spacer (SM-CRM96)	A				
	ISMCRM96AA4	Chaining 34T with spacer (SM-CRM96)	A				
8	Y0JC61000	Spacer	A				
9	Y0X998040	Protection sticker (2 pcs.)	A				
10	Y13098720	TL-FC41 Front chaining direct mount tool	A	A	A	A	A
11	Y13098000	TL-FC36 Bottom bracket cup tool	A	A	A	A	A

A: Same parts.

B: Parts are usable, but differ in materials, appearance, finish, size, etc.

Absence of mark indicates non-interchangeability.

Specifications are subject to change without notice.

Torque information is listed.

Jun.-2025-5071

© Shimano Inc. I

SHIMANO

