

XTR Front Wheel
WH-M9200-TL-F15-B-29

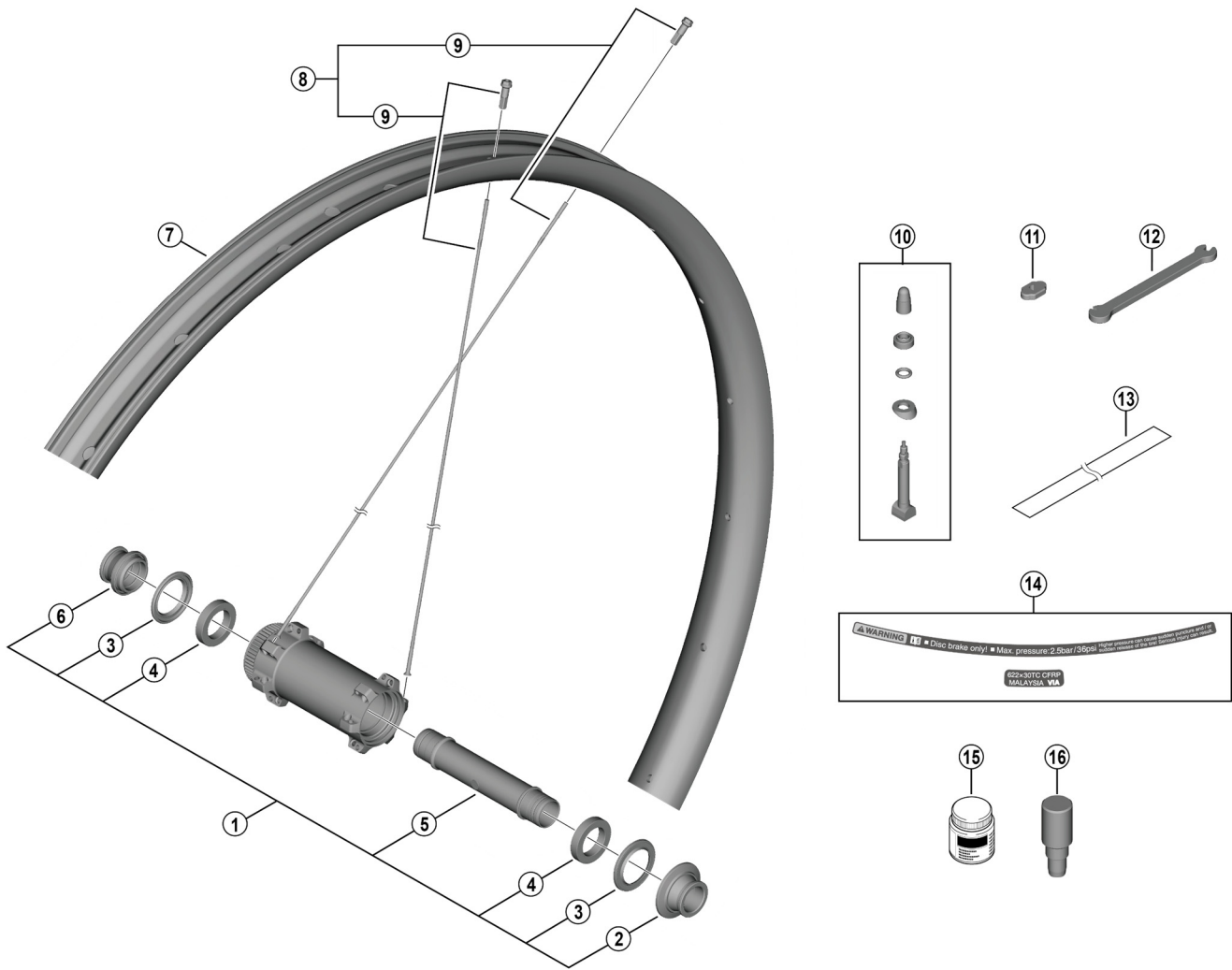

• O.L.D. 110 mm

ITEM NO.	SHIMANO CODE NO.	DESCRIPTION	INTERCHANGE-ABILITY		
1	Y0TW98020	Complete hub axle			
2	Y2LF98020	Right cap	A	A	
3	Y27X14000	Seal ring	A	A	
4	Y0TW9801T	Sealed cartridge bearing (17 x 26 x 5 / C3)			
5	Y0TW98030	Hub axle			
6	Y2LF98040	Left cap	A	A	
7	-	Rim {24H}			
8	-	Spoke unit {spoke (300 mm x 24 pcs.) / nipple (24 pcs.)}			
9	Y0TW98010	Spoke (300 mm/1 pc.) and nipple (1 pc.)			
10	Y0TW98040	Valve unit	A		
11	Y4RJ10000	Valve tool	A		
12	Y0MK14000	TL-WHR92 Nipple wrench 3.4	A		
13	Y0TW9802T	Tubeless tape	A		
14	Y0TW98050	Rim sticker unit			
15	Y38Z98000	Seal grease for freehub (50 g)	A	A	
16	Y2LF9802T	TL-HB017 Hub bearing remover	A	A	

A: Same parts.

B: Parts are usable, but differ in materials, appearance, finish, size, etc.

Absence of mark indicates non-interchangeability.

Specifications are subject to change without notice.

Torque information is listed.

Jun.-2025-5122

© Shimano Inc. I

SHIMANO

