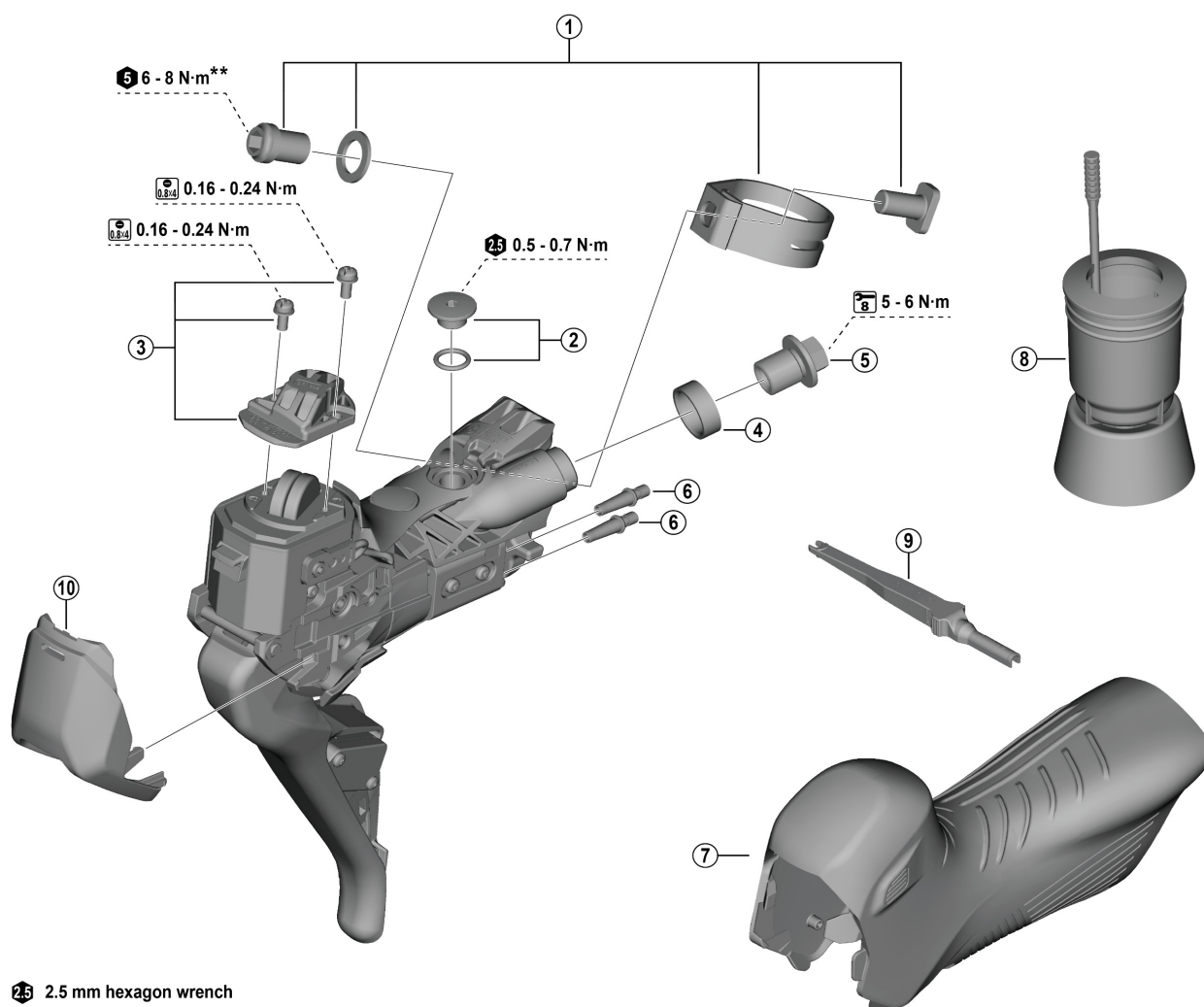

## GRX DUAL CONTROL LEVER (For Disc Brake)

**ST-RX825** (2x12-speed)

2.5 mm hexagon wrench

5 mm hexagon wrench

Slotted screwdriver (nominal dia. 0.8 × 4)

8 mm spanner

**\*\*** When installing parts onto a carbon frame/handlebar, confirm the recommended tightening torque with the carbon frame or handlebar manufacturer. This will prevent damage to the frame/handlebar due to over-torquing or inadequate securing of the components.

ITEM NO.	SHIMANO CODE NO.	DESCRIPTION	INTERCHANGEABILITY		
			ST-RX815	ST-RX820	
1	Y0SL98030	Clamp band unit diameter (23.8 - 24.2 mm)			
2	Y0F398030	Bleed screw and O-ring	A		
3	Y0SL98010	Battery holder R and fixing screws			
	Y0SM98010	Battery holder L and fixing screws			
4	Y0RM9801T	Joint support ring	B	A	
5	Y8RD02000	Flange flare nut (M9/black)	A	A	
6	Y7HE30000	Dummy plug			
7	Y0SL98020	Bracket covers (pair)			
8	Y13000090	TL-BR002 Funnel unit for M7 screw	B	A	
9	Y7HE40000	TL-EW300 Plug tool			
* 10	Y0SL98040	Front cover R			
* 10	Y0SM98020	Front cover L			

A: Same parts.

B: Parts are usable, but differ in materials, appearance, finish, size, etc.

Absence of mark indicates non-interchangeability.

Specifications are subject to change without notice.

Torque information is listed.

Jun.-2025-5053B

© Shimano Inc. I

**SHIMANO**



quefairedemesdechets.fr