

S501-S200 series T5 LED Tube
High efficiency | Wattage switchable

200lm/w



Specification

Factory P/N: SL-S501-S200

Version No.: Ver 02

Date: 2020.08.19

Client approval	Approval	Approval	Confirmation



Applications

- ◆ Indoor illumination at -20° ~ $+48^{\circ}$ C
- ◆ Living area illumination
- ◆ Office area illumination
- ◆ Workshop area illumination
- ◆ Parking lot & hotel area illumination
- ◆ Super market & grocery store illumination



Benefits

- ◆ A6063 aluminum material with excellent heat dissipation, not easy to deform
- ◆ SPD 3KV, effectively prevent the tube from being damaged by on-off switch or instant high voltage
- ◆ Special coating to avoid aluminum exposure
- ◆ Optimal energy conversion, much lower temperature
- ◆ Suitable for lower ambient temperature using

Features

- ◆ Safer and more reliable, leading technology
- ◆ Greener and more energy saving, durable structure
- ◆ Higher efficacy to save much more energy
- ◆ Longer Lifespan for very less heat

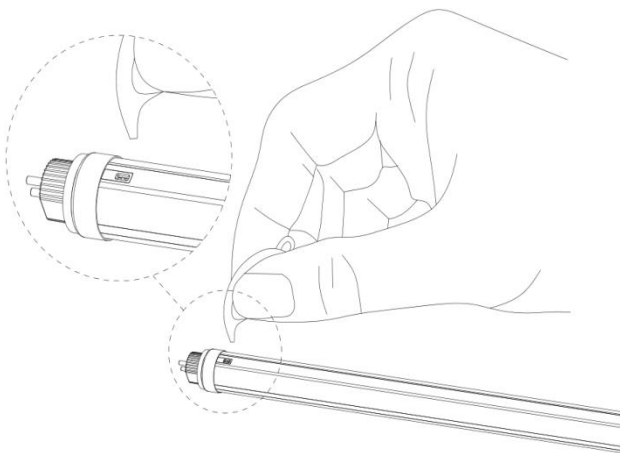
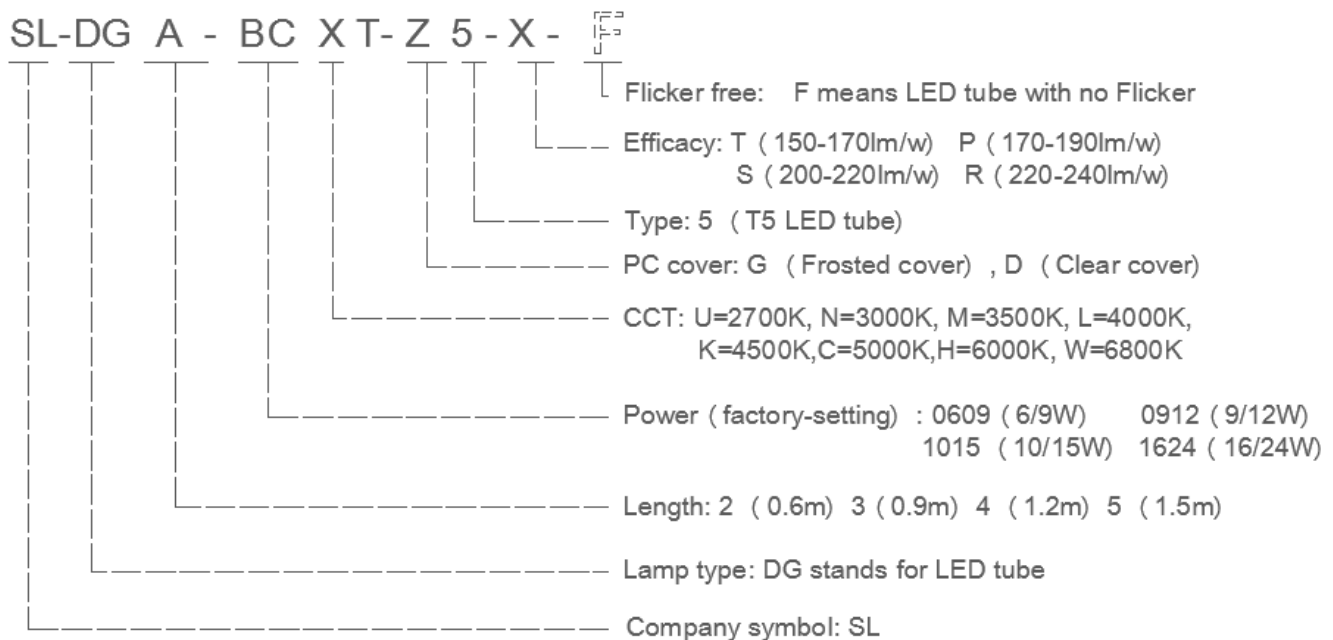

Diagram of code switch for power adjustment

0.6M	<input type="checkbox"/> 6W <input type="checkbox"/> 9W	0.9M	<input type="checkbox"/> 9W <input type="checkbox"/> 12W
1.2M	<input type="checkbox"/> 10W <input type="checkbox"/> 15W	1.2M	<input type="checkbox"/> 16W <input type="checkbox"/> 24W
1.5M	<input type="checkbox"/> 16W <input type="checkbox"/> 24W	1.5M	<input type="checkbox"/> 20W <input type="checkbox"/> 24W

■ Model number naming rules:

S501 series Tube



— This series of products are all named according to the above rules —

■ Product Dimension:

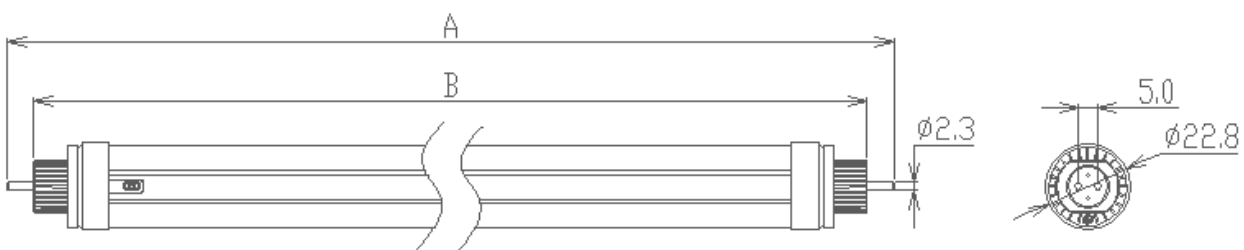

	0.6m	0.9m	1.2m	1.5m
A	563mm	863mm	1163mm	1463mm
B	548mm	848mm	1148mm	1448mm

■ Basic technical parameters

Product Length	0.6m		1.2m		1.5m
Rated Power Switchable	6W	15W	18W	20W	16W
Efficacy	200LM/W				
Rated current	0.5A				
PF	0.92				
CCT	3000K / 4000K / 5000K / 5700K / 6000K / 6500K				
CRI	≥80				
Beam angle	Clear cover 120° / Frosted cover 140°				
Start time	< 0.5S				
Heating time	0.5 hours (heating 60%)				
Dimmable	NO				

■ Life Time:

Nominal Lifespan	100000H
Rated Lifespan	100000H
Turn on-off Times	40000
Luminous flux maintenance rate	> 70%

■ Certificate/Standard:

IP level	IP20
Certificates	TUV-CE/SAA/CE/RoHS/LM79
Energy efficiency rating	A++
Energy consumption	> 70%

■ Reliability tests

	Equipment	Standard	Time/times	Sampling QTY	Result
High temperature	High-low Temp Chamber	IEC60068-2-2	24H	10	OK
Low temperature	High-low Temp Chamber	IEC60068-2-2	24H	10	OK
High-Low Temp.	High-low Temp Chamber	IEC60068-2-38	24H	10	OK
Drop test	Drop test stand	IEC60068-2-32	10 times	6	OK
Vibration	Vibration tester	IEC60068-2-64	30min	6	OK
Impact test	AC power supply/relay	Normal temp/volt	on 30s/off 30s 10000 times	6	OK
Adhesion test	Knife/Tape	GBT9286-1998	10 times	10	OK



■ Detailed parameters

Main model	SL-DG2-0606XT-G5-S-F	SL-DG4-1515XT-G5-S-F	SL-DG4-1818XT-G5-S-F	SL-DG4-2020XT-G5-S-F	SL-DG5-1616XT-G5-S-F
Power:	6W	15W	18W	20W	16W
Luminous flux:	1200LM	3000LM	3600LM	4000LM	3200LM
CCT:	3000K/4000K/5000K/5700K/6000K/6500K				
Input Volt:	AC100-240V				
Frequency:	50/60Hz				
CRI:	≥80				
PF:	0.92				

■ Main components



- ◆ A: Aluminum - A6063 aluminum with high temperature resistant surface painting
- ◆ B: PC cover - imported PC with high light transmission material
- ◆ C: LED+PCB light source assembly
- ◆ D: Aluminum ring—high-quality aluminum with white color painting
- ◆ E: standard G5 end cap
- ◆ F: high-efficient driver
- ◆ G: Switch-code assembly
- ◆ H: Rotatable end cap is optional

■ Optical parameter diagram

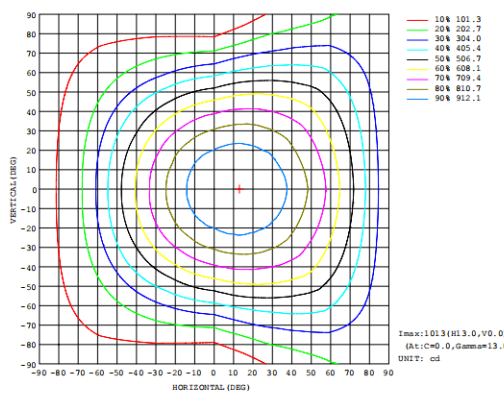
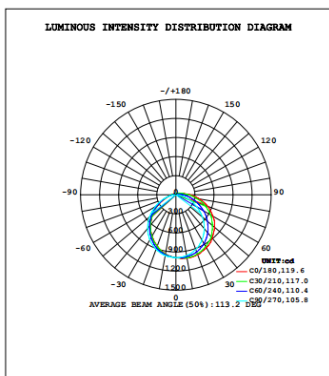

Flux out:1920 lm

Height	Savg, Rmax	Angle:105.79deg	Diameter
1m	347.1, 994.9lx		264.41cm
2m	86.77, 248.7lx		528.82cm
3m	38.56, 110.5lx		793.23cm
4m	21.69, 62.18lx		1057.65cm
5m	13.88, 39.80lx		1322.06cm
6m	9.641, 27.64lx		1586.47cm
7m	7.083, 20.30lx		1850.88cm
8m	5.423, 15.55lx		2115.29cm
9m	4.285, 12.28lx		2379.70cm
10m	3.471, 9.949lx		2644.12cm

Note: The Curves indicate the illuminated area and the average illumination when the luminaire is at different distance.

■ Standard power connection:

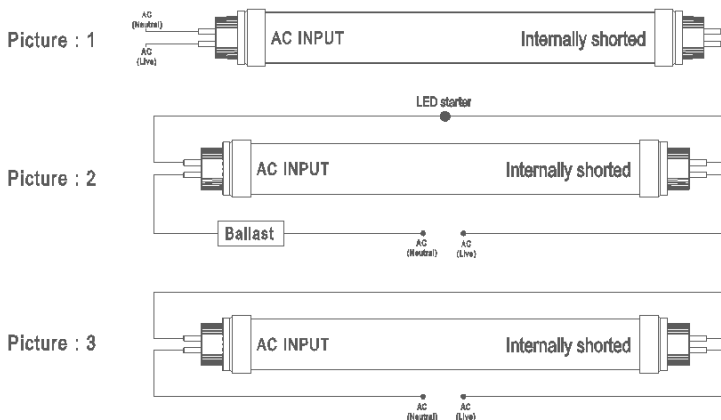

◆ Installation

WARNING: Do not connect mains to "internally shorted" end! follow picture 1.

Magnetic ballast retrofit: remove starter and replace with a LED starter, follow picture2.

Electronic ballast: remove ballast from the circuit, **WARNING!** Only a trained electrician can do this modification! follow picture 3

— rated input voltage AC100-240V —

■ Installation and precautions:

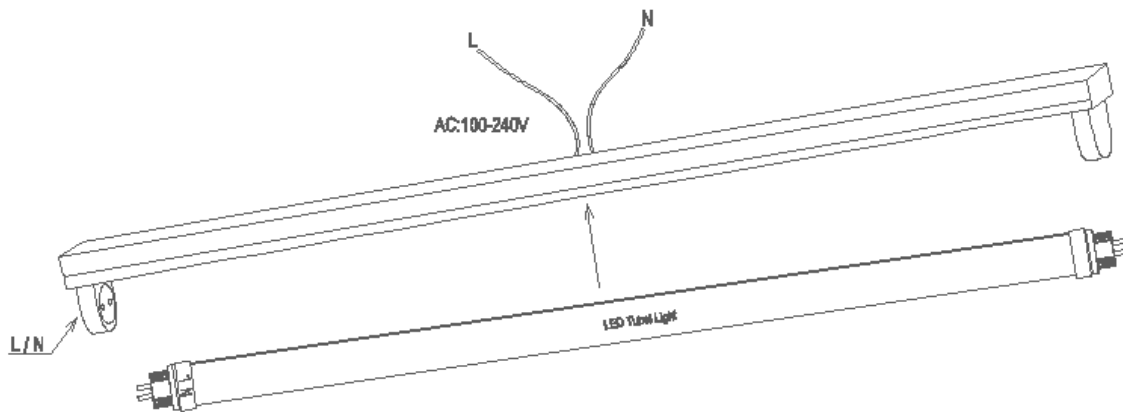

Installation steps:

- ◆ Turn off the power before installation
- ◆ Make sure the working circuit conforms to the schematic diagram of the product or modify the circuit according to the power connection schematic diagram.
- ◆ Confirm the live end of the lamp holder, the other end cannot be connected to live line, and confirm which is the input end of the lamp.
- ◆ When the tube has a label with a clear AC input mark in one end and another end is short-circuit end, then the short-circuit end cannot be connected to the power inlet of the bracket.
- ◆ Install the tube in the bracket correctly and check whether it has been installed properly.
- ◆ Close the power switch to energize after above steps all finished

Precautions:

- ◆ Make sure to disconnect the power supply before installing or removing the lamp
 - ◆ and use the lamp in the rated voltage range.
 - ◆ Indoor use only, do not use this product in high humidity or dusty environment.
 - ◆ Contact the professional maintenance staff to handle if there is any deflection.
 - ◆ Do not look at the lamp for long time when the lamp is working,
 - ◆ because the high-brightness light source may cause eye discomfort or damage.
 - ◆ This lamp is a non-dimmable product, please do not use it with a dimmer.
 - ◆ The lamp should not be used near flammable objects
-
- Warning: The lamp can't be covered by heat heat-proof pad or similar material.
 - Warning: To reduce the risk of fire and clicks, do not modify the external structure of the lamp (aluminum groove and end cover) and internal parts by yourself.
 - Warning: In order to reduce the risk of fire and clicks, the mechanics shall understand the electrical system if they need to install the lamp setting.
 - Warning: To prevent damage or abrasion of the wire, please do not expose the wire to the edge of a metal sheet or any other sharp objects.

■ ERP Labels

