

iSi GmbH Kürschnergasse 4 A-1217 Vienna	Product information	No.: SMB.I.055.e.01
	Issue: June 2016	Page: 1 of 3
Product data sheet Soda Siphon stainless steel 0.75 L/1 L		

PRODUCT DATA SHEET

Soda Siphon stainless steel 0.75 l (1004)

Soda Siphon stainless steel 1 l (1020)

DESCRIPTION

The Whipper consists of the head part, stainless steel bottle with a measuring tube, and riser tube. Only iSi CO₂ chargers are used for the gassing. The gassing takes place using a charger holder. The dispensing valve is fixed in place in the head.



AREA OF APPLICATION

The pro for every bar – 0.75 L / 1 L refreshingly sparkling soda water with that extra fizz. Ideal for adding sparkle to long drinks & cocktails. The Whipper is not dishwasher-safe! The Whipper is only suitable for cold applications.

TECHNICAL DATA

Bottles are 100% tested under test pressure (see below).

Heads are 100% tested for function.

The Whipper consists of the following components and accessories.

iSi GmbH Kürschnergasse 4 A-1217 Vienna	Product information	No.: SMB.I.055.e.01
	Issue: June 2016	Page: 2 of 3
Product data sheet Soda Siphon stainless steel 0.75 L/1 L		

LIST OF COMPONENTS	Material
Bottle	Stainless steel
Whipper head	PA, nickel-plated ABS, POM, silicone, nickel-plated brass, PU, stainless steel
Riser tube/gasket	PE, TPE
Measuring tube	PP, NBR
Charger holder	Chrome-plated zinc die casting, silicone
Measuring tube key	ABS

Pressure level	0.75 l	1 l
Maximum allowable operating pressure P_s	16 bar	16 bar
Minimum test pressure P_t	25 bar	25 bar
Minimum operating temperature	1 °C	1 °C
Maximum operating temperature	30 °C	30 °C
Maximum filling volume	0.75 L	1 L
Maximum number of chargers to be used	1 iSi soda charger	1 iSi soda charger

Measurements and weight	0.75 l	1 l
Product weight (net)	650 g	720 g
Total height (with tip)	290 mm	310 mm
Bottle diameter	95 mm	98 mm

Exploded view

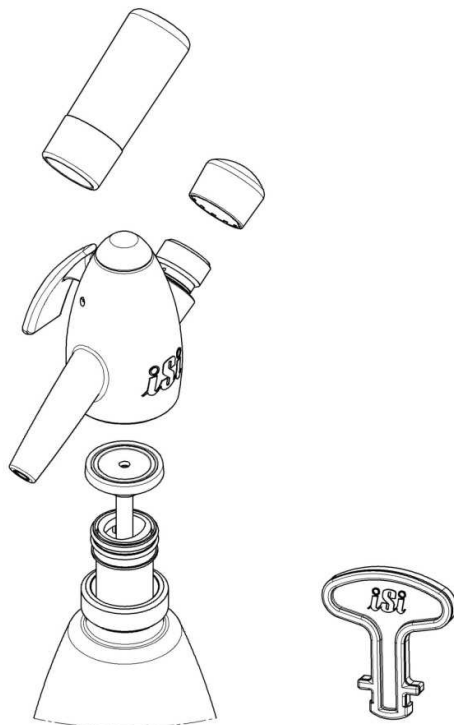

iSi GmbH Kürschnergasse 4 A-1217 Vienna	Product information	No.: SMB.I.055.e.01
	Issue: June 2016	Page: 3 of 3
Product data sheet Soda Siphon stainless steel 0.75 L/1 L		

LOGISTICAL DATA

	0.75 l	1 l
Country of origin – finished product	China	
Customs tariff number	7323 9300	
Type of packaging	Cardboard	
Size of packaging (BHT) cm	9.5x29.3x9.6	10.3x32.1x10.3
Weight per unit	0.89 kg	0.90 kg
Unit per outer box	6	6
Unit per EURO pallet/one-way pallet	144/96	144/96
Outer box weight	5.7 kg	5.7 kg
EURO pallet size cm	120x80x76.9	120x80x76.9
One-way pallet size cm	90x67x74.4	90x67x74.4

CERTIFICATES

Soda Siphon stainless steel complies with European Regulations 1935/2004 and 10/2011 for materials in contact with food, and may carry the wine glass and fork symbol.

Soda Siphon stainless steel is pressure equipment with low hazard potential, and may not be labeled with a CE sign according to European Regulation 97/23/EG (PED), last changed by the provision 2012/1025/EU.

WARNINGS AND HANDLING

The safety instructions and operating instructions for the soda siphons and chargers must be strictly observed.

For chargers, see respective product data sheet.

Improper use can put your health at risk.

Unsuitable and not permitted for purposes other than those expressly stated.

Filled container is pressurized.

Keep out of reach of children.

STORAGE

The unfilled Whippers must be stored in a dry place at temperatures between -20°C and 50°C. Storage outdoors is not permissible.

TRACEABILITY

The Whippers are labeled with a batch number on the bottom of the bottle as well as on the underside of the head.

Creators: TOP/HOEFF/NOH	Auditors: TOP/CFE	Released by: SMB/KRE & THS 04.07.2016
-------------------------	-------------------	---------------------------------------