

# TIAGRA Dual Control Lever

## ST-4700 (2x10-speed)

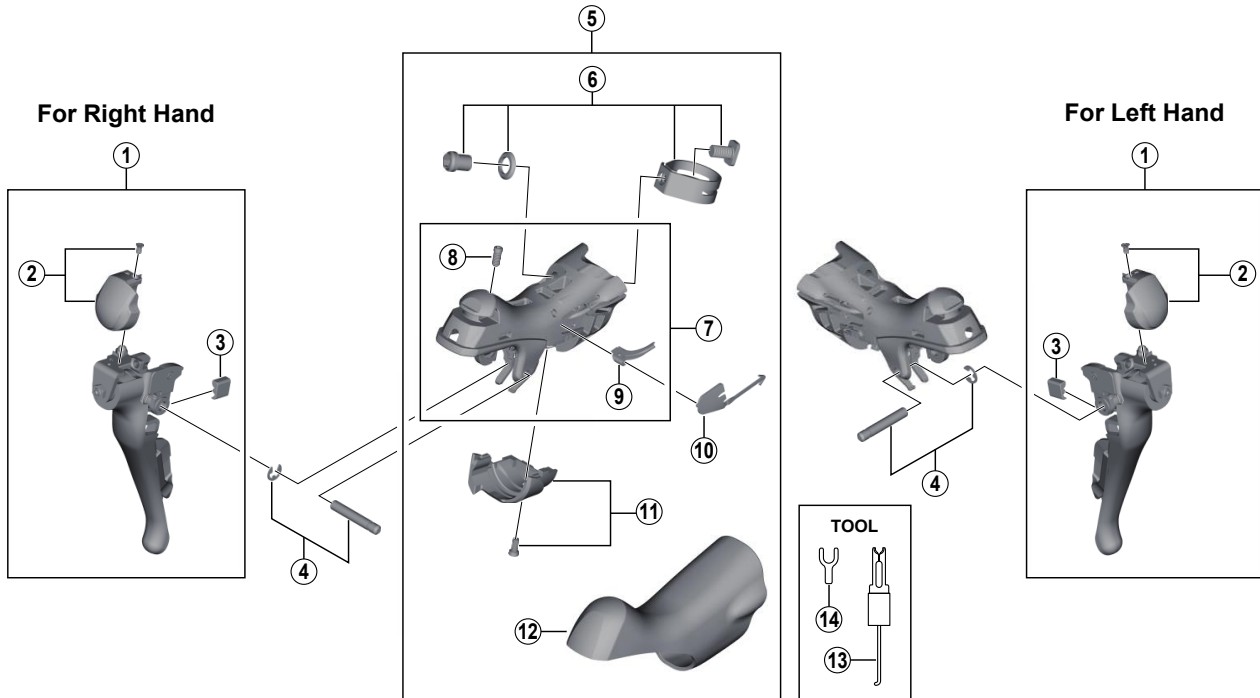

ITEM NO.	SHIMANO CODE NO.	DESCRIPTION	INTERCHANGEABILITY	
			ST-6800	ST-5800
1	Y02L98010	R.H. Main Lever Assembly		
	Y02M98010	L.H. Main Lever Assembly		
2	Y02L98030	R.H. Name Plate R & Fixing Screw		
	Y02M98030	L.H. Name Plate L & Fixing Screw		
3	Y63X80000	R.H. Main Lever Support R	A	A
	Y63X80010	L.H. Main Lever Support L	A	A
4	Y01G98070	Lever Axle & E-ring		A
	Y02L98040	R.H. Bracket Assembly		
5	Y02M98040	L.H. Bracket Assembly		
	Y02L98080	Clamp Band Unit (ø23.8 mm - ø24.2 mm)	A	A
7	Y02L98050	R.H. Bracket Unit		
	Y02M98050	L.H. Bracket Unit		
8	Y02M47000	Grip Adjusting Screw		B
	Y63X63000	R.H. SL Cable Guide R	A	A
9	Y63X55000	L.H. SL Cable Guide L	A	A
	Y00E75000	R.H. SL Cable Cover R	A	A
10	Y00F75000	L.H. SL Cable Cover L	A	A
	Y02L98070	R.H. Unit Cover R & Fixing Screw		
11	Y02M98070	L.H. Unit Cover L & Fixing Screw		
	Y00E98080	Bracket Covers (Black/Pair)	A	A
13	Y6RT68000	Tool A for E-ring	A	A
14	Y6RT66000	Tool B for E-ring	A	A

A: Same parts.

B: Parts are usable, but differ in materials, appearance, finish, size, etc.

Absence of mark indicates non-interchangeability.

Specifications are subject to change without notice.

May-2015-3864

© Shimano Inc. I

# SHIMANO