

NEXUS 3-speed Hub w/Hi-Power Roller Brake

SG-3R40-DX Inter-3 Hub

BR-IM41-R Inter-M Brake

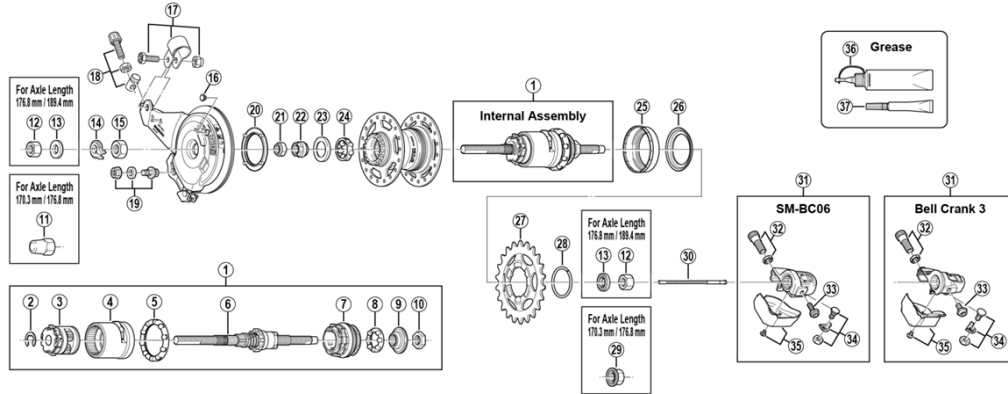

ITEM NO.	SHIMANO CODE NO.	DESCRIPTION
1	Y33S90700	Internal Assembly (Axle Length 170.3 mm)
	Y33S98270	Internal Assembly (Axle Length 176.8 mm)
	Y33S90710	Internal Assembly (Axle Length 189.4 mm)
2	Y33Y19000	Stop Ring (Dia. 9.6 mm)
3	Y33S90400	Carrier Unit
4	Y33S90300	Ring Gear Unit
5	Y33R90220	Ball Retainer K (7/32" x 10)
6	Y33S98040	Axle Unit (Axle Length 170.3 mm)
	Y33S98280	Axle Unit (Axle Length 176.8 mm)
	Y33S98050	Axle Unit (Axle Length 189.4 mm)
7	Y33S90200	Driver Unit
8	Y33R90210	Ball Retainer J (7/32" x 8)
9	Y33R90500	Right Hand Cone with Dust Seal
10	Y33R08100	Right Hand Lock Nut (5 mm) for Axle Length 170.3 mm / 189.4 mm
	Y32530100	Right Hand Lock Nut (9.9 mm) for Axle Length 176.8 mm
11	Y31414010	Cap Nut (3/8") for Axle Length 170.3 mm / 176.8 mm
* 12	Y32170020	Hub Nut (7 mm) for Axle Length 189.4 mm
	Y20003080	Hub Nut (9 mm) for Axle Length 176.8 mm / 189.4 mm
* 13	Y22006050	Washer (2 mm) for Axle Length 176.8 mm / 189.4 mm
	Y22006040	Washer (3.2 mm) for Axle Length 189.4 mm
14	Y33Z20200	Non-turn Washer 2 (Yellow)
* 15	Y75V13000	Brake Unit Fixing Nut (8.2 mm) for Axle Length 170.3 mm / 189.4 mm
	Y75V13010	Brake Unit Fixing Nut (9.7 mm) for Axle Length 176.8 mm
16	Y75F11000	Grease Hole Cap
17	Y33S98520	Brake Arm Clip Unit (Dia. 14 mm)
	Y33S98530	Brake Arm Clip Unit (Dia. 22 mm)
	Y33F98090	Brake Arm Clip Unit (5/8")
	Y75M98060	Brake Arm Clip Unit (11/16")
	Y33F98100	Brake Arm Clip Unit (3/4")
18	Y75P98080	Brake Cable Adjusting Bolt Unit (Silver)
19	Y75M98070	Inner Cable Fixing Bolt Unit (Silver)
20	Y75P17000	Seal Ring for Brake
21	Y31Z06020	Lock Nut for Left Hand Cone
22	Y33M37000	Left Hand Cone
23	Y31Z07000	Left Hand Dust Cap
24	Y32190220	Ball Retainer A (1/4" x 7)
25	Y33R05000	Right Hand Dust Cap A
26	Y33R52001	Right Hand Dust Cap B
27	Y32203220	Sprocket Wheel 16T (Silver)
	Y32203420	Sprocket Wheel 18T (Silver)
	Y32203520	Sprocket Wheel 19T (Silver)
	Y32203620	Sprocket Wheel 20T (Silver)
	Y33060000	Sprocket Wheel 21T (Silver)
	Y33060100	Sprocket Wheel 22T (Silver)
	Y33060200	Sprocket Wheel 23T (Silver)
* 28	Y32520110	Snap Ring C
29	Y22015010	Flange Nut for Axle Length 170.3 mm / 176.8 mm
30	Y33S98180	Push Rod (86.85 mm) for Axle Length 176.8 mm
	Y33S98290	Push Rod (90.75 mm) for Axle Length 189.4 mm
31	Y6P198030	SM-BC06 Bell Crank Unit
	Y33S95100	Bell Crank 3 Unit
32	Y33S98010	Cable Adjusting Bolt and Nut for SM-BC06
	Y33S98500	Cable Adjusting Bolt and Nut for Bell Crank 3
33	Y33S74000	Bell Crank Body Fixing Screw for SM-BC06
	Y33S57000	Bell Crank Body Fixing Screw for Bell Crank 3
34	Y33S98030	Inner Cable Fixing Bolt Unit for SM-BC06
	Y33S98510	Inner Cable Fixing Bolt Unit for Bell Crank 3
35	Y6P198040	Bell Crank Cover and Fixing Screw for SM-BC06
	Y33S98020	Bell Crank Cover and Fixing Screw for Bell Crank 3
36	Y04120800	Internal Hub Grease (Net. 100 g)
	Y04120400	Roller Brake Grease (Net. 100 g)
37	Y04140020	Roller Brake Grease (Net. 10 g)

Aug.-2020-2990B

© Shimano Inc. I

Specifications are subject to change without notice.

SHIMANO