

DEORE Front Hub HB-M525-A For Disc Brake

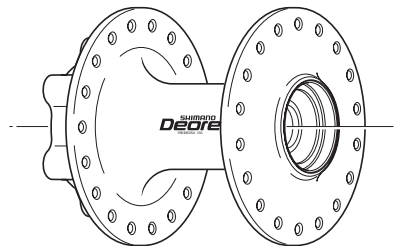
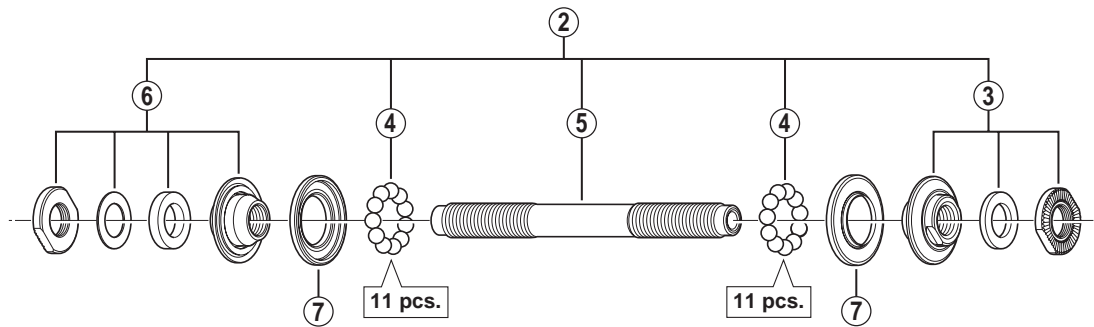
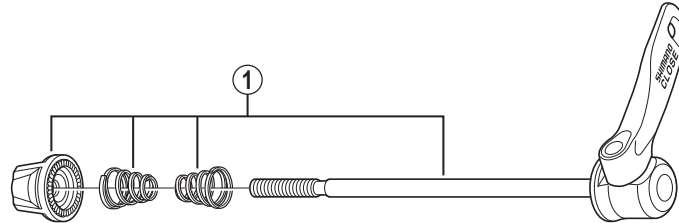

• Over Lock Nut Dimension: 100 mm (3-15/16")

| ITEM NO. | SHIMANO CODE NO. | DESCRIPTION | INTERCHANGEABILITY |
|----------|------------------|--|--------------------|
| 1 | Y2ZB98030 | Complete Quick Release 133 mm (5-1/4") | A |
| 2 | Y2SW98020 | Complete Hub Axle 108 mm (4-1/4") | |
| 3 | Y2SW98030 | Right Hand Lock Nut Unit | |
| 4 | Y4BB98030 | Steel Ball (3/16") 22 pcs. | A |
| 5 | Y21S02000 | Hub Axle M10 x 108 mm (4-1/4") | B |
| 6 | Y2SW98040 | Left Hand Lock Nut Unit | |
| 7 | Y2TA06000 | Seal Ring | |

A: Same parts.

B: Parts are usable, but differ in materials, appearance, finish, size, etc.

Absence of mark indicates non-interchangeability.

HB-M525

Jul.-2011-3288
© Shimano Inc. I

Specifications are subject to change without notice.

SHIMANO