

ACERA Front Chainwheel

FC-M361 -S Silver Version
FC-M361 -L Black Version

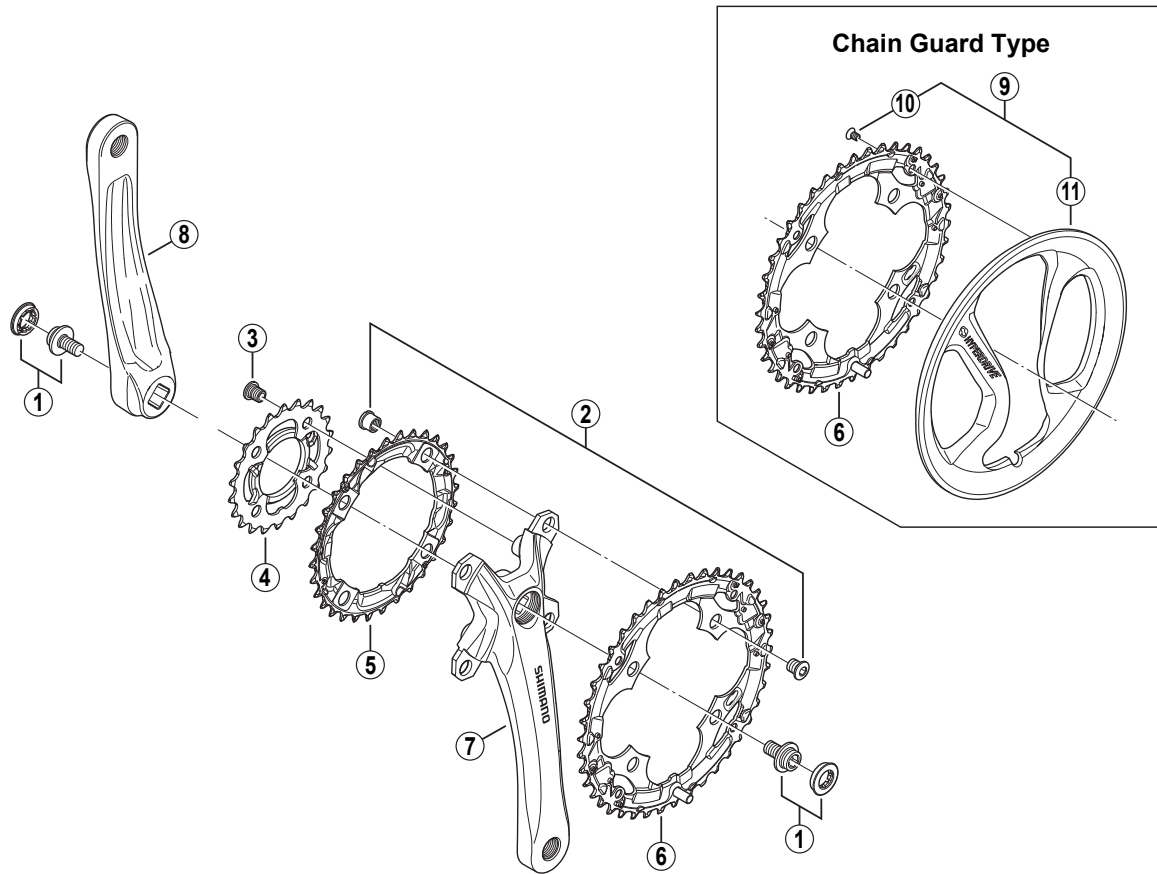

- Chaining teeth combinations: 42-32-22T / 48-38-28T
- Bolt circle diameter: 104 mm...(For outer gear and middle gear), 64 mm...(For inner gear)

FC-M361-8
 FC-M341
 FC-M311

ITEM NO.	SHIMANO CODE NO.	DESCRIPTION	INTERCHANGEABILITY
1	Y-16M90100	Crank Arm Fixing Bolt & Cap	A
2	Y-1FM98020	Double Gear Fixing Bolt (M8 x 8.5) & Nut (4 sets)	A A
3	Y-1FM98030	Inner Gear Fixing Bolt (M8 x 8.5 / 4 pcs.)	A A
4	Y-1KN98010	Chainring 22T (Black) & Chain Protector	A
	Y-1KN98020	Chainring 28T (Black) & Chain Protector	
5	Y-1KN98030	Chainring 32T (Black)	A
	Y-1KN98040	Chainring 38T (Black)	
	Y-1KN98050	Chainring 42T (Black)	A
6	Y-1KN98060	Chainring 48T (Black)	
	Y-1KN05000	Right Hand Crank Arm 170 mm (Silver) for FC-M361-S	
7	Y-1KN05010	Right Hand Crank Arm 170 mm (Black) for FC-M361-L	
	Y-1KN03000	Right Hand Crank Arm 175 mm (Silver) for FC-M361-S	
	Y-1KN03010	Right Hand Crank Arm 175 mm (Black) for FC-M361-L	
	Y-1KN05100	Left Hand Crank Arm 170 mm (Silver) for FC-M361-S	
8	Y-1KN05110	Left Hand Crank Arm 170 mm (Black) for FC-M361-L	
	Y-1KN03100	Left Hand Crank Arm 175 mm (Silver) for FC-M361-S	
	Y-1KN03110	Left Hand Crank Arm 175 mm (Black) for FC-M361-L	
	Y-1KN98070	Chain Guard for 42T & Fixing Screws	A
9	Y-1KN98080	Chain Guard for 48T & Fixing Screws	
	Y-1KN98090	Chain Guard Fixing Screw (4 pcs.)	A
11	Y-1KN12000	Chain Guard for 42T	A
	Y-1KN13000	Chain Guard for 48T	

A: Same parts.

B: Parts are usable, but differ in materials, appearance, finish, size, etc.

Absence of mark indicates non-interchangeability.

0802-2793

Specifications are subject to change without notice.

SHIMANO