

ALIVIO Crankset FC-T4010 BB-ES25

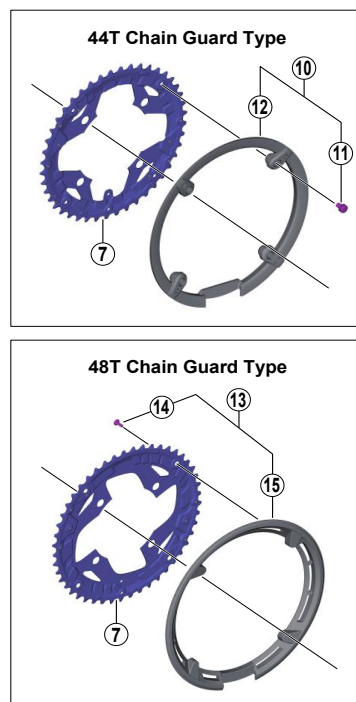
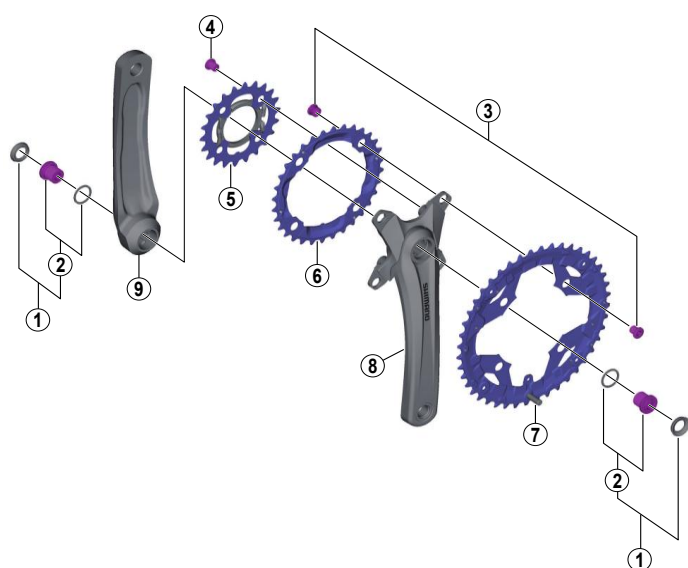

- Chaining teeth combinations: 44-32-22T / 48-36-26T
- Bolt circle diameter: 104 mm...(For outer gear and middle gear), 64 mm...(For inner gear)

FC-T4060

FC-M431-8

ITEM NO.	SHIMANO CODE NO.	DESCRIPTION	INTERCHANGEABILITY	
1	Y1PL98010	Crank Arm Fixing Bolt Unit		B
2	Y1M098020	Crank Arm Fixing Bolt & Washer		A
3	Y1NL98110	Double Gear Fixing Bolt (M8 x 8.5) & Nut (4 sets)	A	
4	Y1FM98030	Inner Gear Fixing Bolt (M8 x 8.5 / 4 pcs.)	A	
5	Y1ME98020	Chaining 22T & Chain Protector for 44-32-22T		B
	Y1PN98030	Chaining 26T & Chain Protector for 48-36-26T		B
6	Y1LD98080	Chainring 32T for 44-32-22T	A	B
	Y1LD98090	Chainring 36T for 48-36-26T	A	B
7	Y1PN98060	Chainring 44T for 44-32-22T (Silver)	A	B
	Y1PN98210	Chainring 44T for 44-32-22T (Black)	A	B
	Y1PN98070	Chainring 48T for 48-36-26T (Silver)	A	B
	Y1PN98220	Chainring 48T for 48-36-26T (Black)	A	B
8	Y1PN98080	Right Hand Crank Arm 165 mm (Silver)		B
	Y1PN98090	Right Hand Crank Arm 165 mm (Black)		B
	Y1PN98100	Right Hand Crank Arm 170 mm (Silver)		B
	Y1PN98110	Right Hand Crank Arm 170 mm (Black)		B
	Y1PN98120	Right Hand Crank Arm 175 mm (Silver)		B
	Y1PN98130	Right Hand Crank Arm 175 mm (Black)		B
9	Y1PN98140	Left Hand Crank Arm 165 mm (Silver)		B
	Y1PN98150	Left Hand Crank Arm 165 mm (Black)		B
	Y1PN98160	Left Hand Crank Arm 170 mm (Silver)		B
	Y1PN98170	Left Hand Crank Arm 170 mm (Black)		B
	Y1PN98180	Left Hand Crank Arm 175 mm (Silver)		B
	Y1PN98190	Left Hand Crank Arm 175 mm (Black)		B
10	Y1M098250	44T Chain Guard & Fixing Bolts	A	A
11	Y1M098260	44T Chain Guard Fixing Bolt (4 pcs.)	A	A
12	Y1GX14100	44T Chain Guard	A	A
13	Y1PN98200	48T Chain Guard & Fixing Bolts	A	B
14	Y1D298010	48T Chain Guard Fixing Bolt (4 pcs.)	A	A
15	Y1PM11000	48T Chain Guard	A	B

A: Same parts.

B: Parts are usable, but differ in materials, appearance, finish, size, etc.

Absence of mark indicates non-interchangeability.

Jul.-2014-3661

© Shimano Inc. H

Specifications are subject to change without notice.

SHIMANO