

Cassette Sprocket (10-Speed)  
**CS-HG81-10** bj/bk/bL-Group

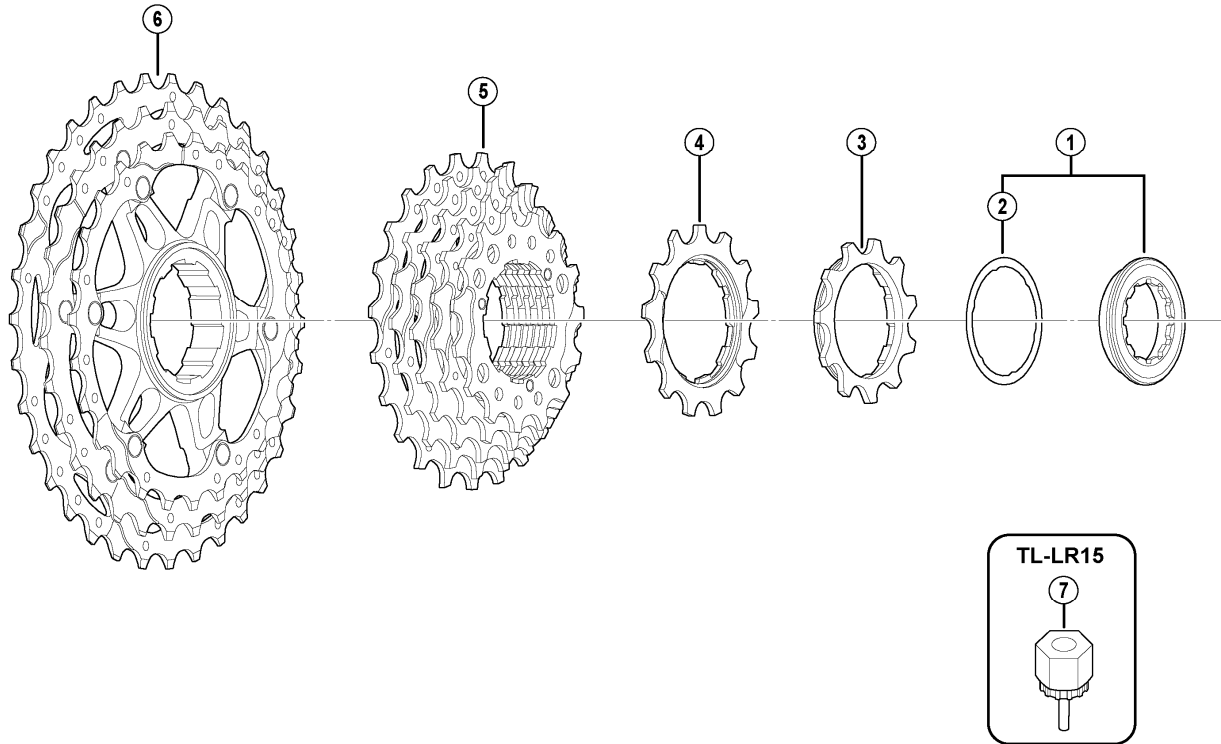

- bj-group sprocket teeth combination: 11-13-15-17-19-21-23-26-30-34T
- bk-group sprocket teeth combination: 11-13-15-17-19-21-24-28-32-36T
- bL-group sprocket teeth combination: 11-12-14-16-18-20-22-25-28-32T

ITEM NO.	SHIMANO CODE NO.	DESCRIPTION	INTERCHANGEABILITY
1	Y1YS98010	Lock Ring & Spacer	
2	Y10Z04000	Lock Ring Spacer	
* 3	Y1YS11000	Sprocket Wheel 11T (Built in spacer type) for bj/bk-Group	
	Y1YS11100	Sprocket Wheel 11T (Built in spacer type) for bL-Group	
* 4	Y1YS13000	Sprocket Wheel 13T (Built in spacer type) for bj/bk-Group	
	Y1YS12000	Sprocket Wheel 12T (Built in spacer type) for bL-Group	
	Y1YS98030	Sprocket Unit (15-17-19-21-23T) for bj-Group	
5	Y1YS98040	Sprocket Unit (15-17-19-21-24T) for bk-Group	
*	Y1YS98070	Sprocket Unit (14-16-18-20-22T) for bL-Group	
	Y1YS98050	Sprocket Unit (26-30-34T) for bj-Group (Cassette Sprocket Carrier for 6arm)	
6	Y1YS98060	Sprocket Unit (28-32-36T) for bk-Group (Cassette Sprocket Carrier for 6arm)	
*	Y1YS98080	Sprocket Unit (25-28-32T) for bL-Group (Cassette Sprocket Carrier for 5arm)	
7	Y12009230	Lock Ring Removal Tool (TL-LR15)	

A: Same parts.

B: Parts are usable, but differ in materials, appearance, finish, size, etc.  
 Absence of mark indicates non-interchangeability.

Apr.-2011-3018A  
 © Shimano Inc. A

Specifications are subject to change without notice.

**SHIMANO**