

# ALIVIO Front Chainwheel FC-M430-8

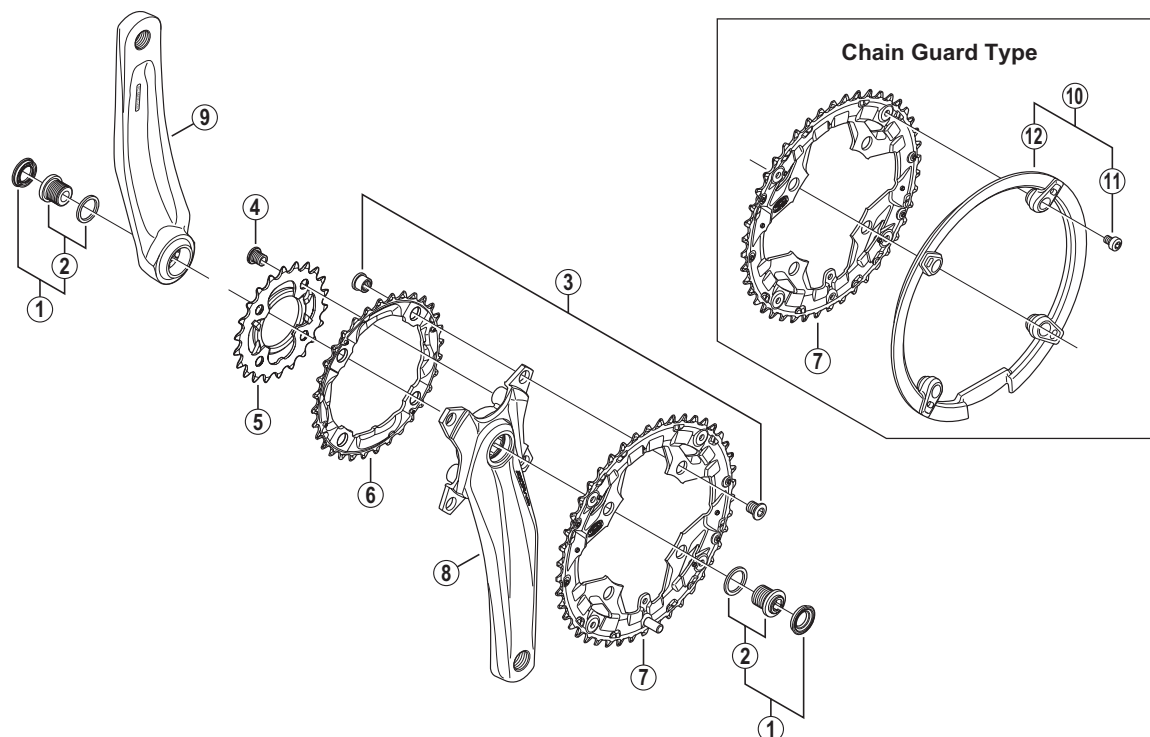

• Bolt circle diameter: 104 mm...(For outer gear and middle gear), 64 mm...(For inner gear)

FC-M430-8  
FC-M430-8-1A

ITEM NO.	SHIMANO CODE NO.	DESCRIPTION	INTERCHANGEABILITY	
1	Y1M098010	Crank Arm Fixing Bolt Unit	A	
2	Y1M098020	Crank Arm Fixing Bolt & Washer	A	
3	Y1FM98020	Double Gear Fixing Bolt (M8 x 8.5) & Nut (4 sets)	A A	
4	Y1FM98030	Inner Gear Fixing Bolt (M8 x 8.5 / 4 pcs.)	A A	
5	Y1M098030	Chainring 22T (Black) & Chain Protector for FC-M430-8-S	A	
	Y1M098040	Chainring 22T (Silver) & Chain Protector for FC-M430-8-L		
6	Y1M098050	Chainring 32T (Black) for FC-M430-8-S	A	
	Y1M098060	Chainring 32T (Silver) for FC-M430-8-L		
7	Y1M098070	Chainring 44T (Black)		
	Y1M098080	Chainring 44T (Black) for Chain Guard		
8	Y1M098090	Right Hand Crank Arm 170 mm (Silver) ALIVIO Logo		
	Y1M098100	Right Hand Crank Arm 170 mm (Black) ALIVIO Logo		
	Y1M098110	Right Hand Crank Arm 175 mm (Silver) ALIVIO Logo		
	Y1M098120	Right Hand Crank Arm 175 mm (Black) ALIVIO Logo		
	Y1M098130	Right Hand Crank Arm 170 mm (Silver) SHIMANO Logo		
	Y1M098140	Right Hand Crank Arm 170 mm (Black) SHIMANO Logo		A
	Y1M098150	Right Hand Crank Arm 175 mm (Silver) SHIMANO Logo		A
	Y1M098160	Right Hand Crank Arm 175 mm (Black) SHIMANO Logo		
9	Y1M098170	Left Hand Crank Arm 170 mm (Silver) ALIVIO Logo		
	Y1M098180	Left Hand Crank Arm 170 mm (Black) ALIVIO Logo		
	Y1M098190	Left Hand Crank Arm 175 mm (Silver) ALIVIO Logo		
	Y1M098200	Left Hand Crank Arm 175 mm (Black) ALIVIO Logo		
	Y1M098210	Left Hand Crank Arm 170 mm (Silver) SHIMANO Logo		A
	Y1M098220	Left Hand Crank Arm 170 mm (Black) SHIMANO Logo		
	Y1M098230	Left Hand Crank Arm 175 mm (Silver) SHIMANO Logo		A
	Y1M098240	Left Hand Crank Arm 175 mm (Black) SHIMANO Logo		
10	Y1M098250	Chain Guard & Fixing Bolts	A	
11	Y1M098260	Chain Guard Fixing Bolt (4 pcs.)	A	
12	Y1GX14100	Chain Guard	A	

A: Same parts.

B: Parts are usable, but differ in materials, appearance, finish, size, etc.

Absence of mark indicates non-interchangeability.

Feb.-2010-3020

© Shimano Inc. I

Specifications are subject to change without notice.

# SHIMANO