

E6000 Series CrankSet

**FC-E6000** Crank Arm  
**SM-CRE60** Gear

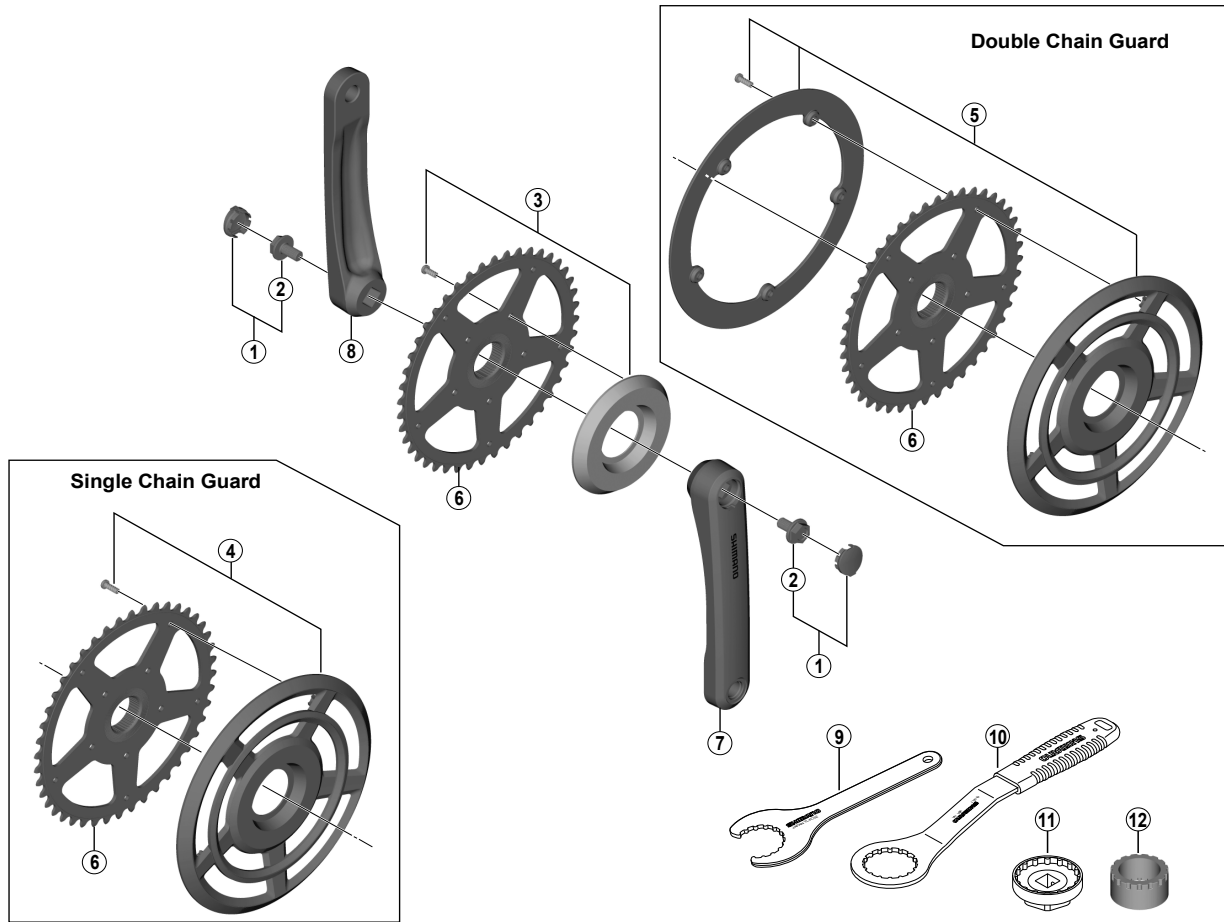

ITEM NO.	SHIMANO CODE NO.	DESCRIPTION
* 1	Y1Y598010	Crank Arm Fixing Bolt Unit for Black
	Y1R298010	Crank Arm Fixing Bolt Unit for Gray
2	Y1SC02000	Crank Arm Fixing Bolt (M8 x 15)
3	Y1R298020	Chain Ring Cover & Fixing Bolt (5 pcs.)
4	Y1R298030	38T Single Chain Ring Cover (1 pc) & Fixing Bolt (1 Unit = 5 pcs.) for Black
	Y1R298070	38T Single Chain Ring Cover (1 pc) & Fixing Bolt (1 Unit = 5 pcs.) for Gray
	Y1R298040	44T Single Chain Ring Cover (1 pc) & Fixing Bolt (1 Unit = 5 pcs.) for Black
	Y1R298080	44T Single Chain Ring Cover (1 pc) & Fixing Bolt (1 Unit = 5 pcs.) for Gray
5	Y1R298050	38T Double Chain Ring Cover (1 pc) & Fixing Bolt (1 Unit = 5 pcs.) for Black
	Y1R298090	38T Double Chain Ring Cover (1 pc) & Fixing Bolt (1 Unit = 5 pcs.) for Gray
	Y1R298060	44T Double Chain Ring Cover (1 pc) & Fixing Bolt (1 Unit = 5 pcs.) for Black
6	Y1R298100	44T Double Chain Ring Cover (1 pc) & Fixing Bolt (1 Unit = 5 pcs.) for Gray
	Y1Y400001	Chain Ring 38T
	Y1Y400002	Chain Ring 44T
* 7	Y1Y502000	Right Hand Crank Arm 170 mm (Black)
	Y1R202000	Right Hand Crank Arm 170 mm (Gray)
* 8	Y1Y502100	Right Hand Crank Arm 175 mm (Black)
	Y1R202100	Right Hand Crank Arm 175 mm (Gray)
* 9	Y1Y501000	Left Hand Crank Arm 170 mm (Black)
	Y1R201000	Left Hand Crank Arm 170 mm (Gray)
	Y1Y501100	Left Hand Crank Arm 175 mm (Black)
* 10	Y1R201100	Left Hand Crank Arm 175 mm (Gray)
	Y13009210	TL-FC32 Adapter Removal Tool
9	Y13098000	TL-FC36 Adapter Removal Tool
10	Y13009230	TL-FC33 Adapter Removal Tool
11	YEZY00010	TL-FC38 Adapter Removal Tool for DU-E6000/ DU-E6001
12		

Jun.-2016-3762C

© Shimano Inc. I

Specifications are subject to change without notice.

**SHIMANO**