

# microSHIFT

## Adjusting Clutch Tension Manual

**ADVENT**

**ADVENTX**

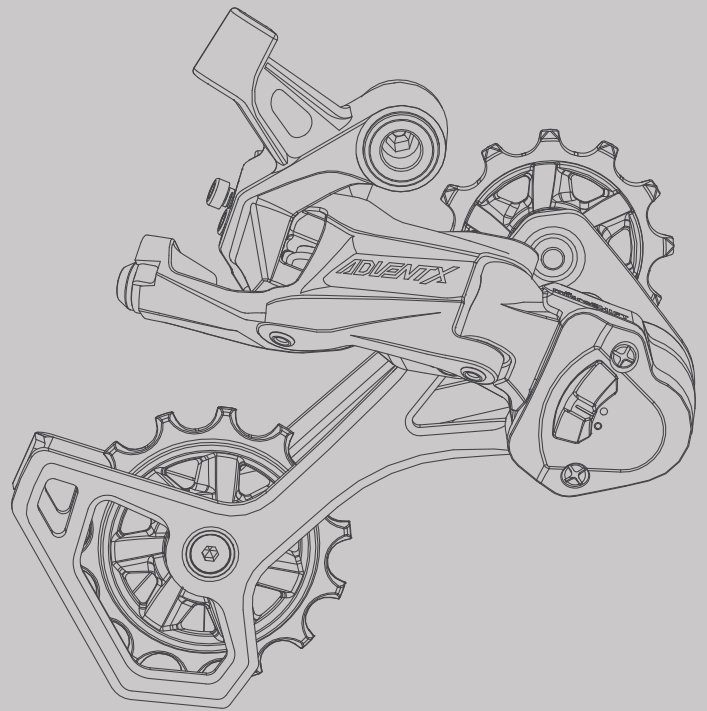
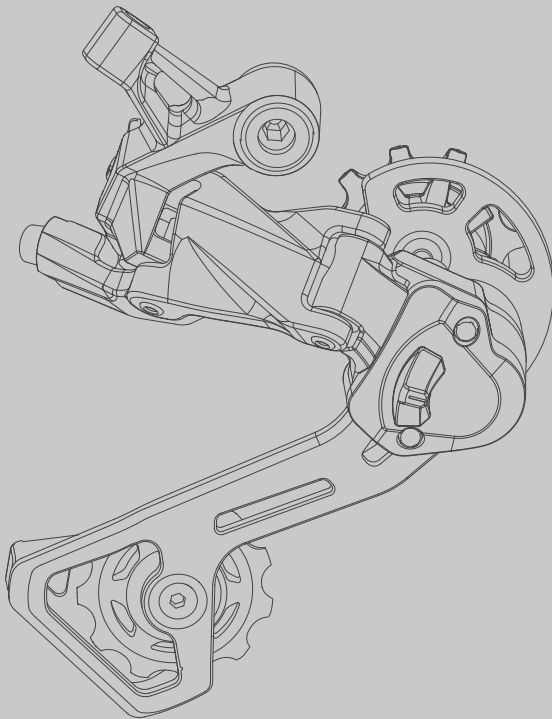

# Important Notice



## REMINDER

Before installing the products, please read and understand the installation procedures. Improper installation can lead to premature product failures or even injuries. If you have any questions on how to install, please contact us or consult with a professional bicycle mechanic.

# Adjusting Clutch Tension

Part I

Turn the clutch to the **on position**.

Use a Philips head screwdriver to unthread **the clutch cover screws** and remove the clutch cover.

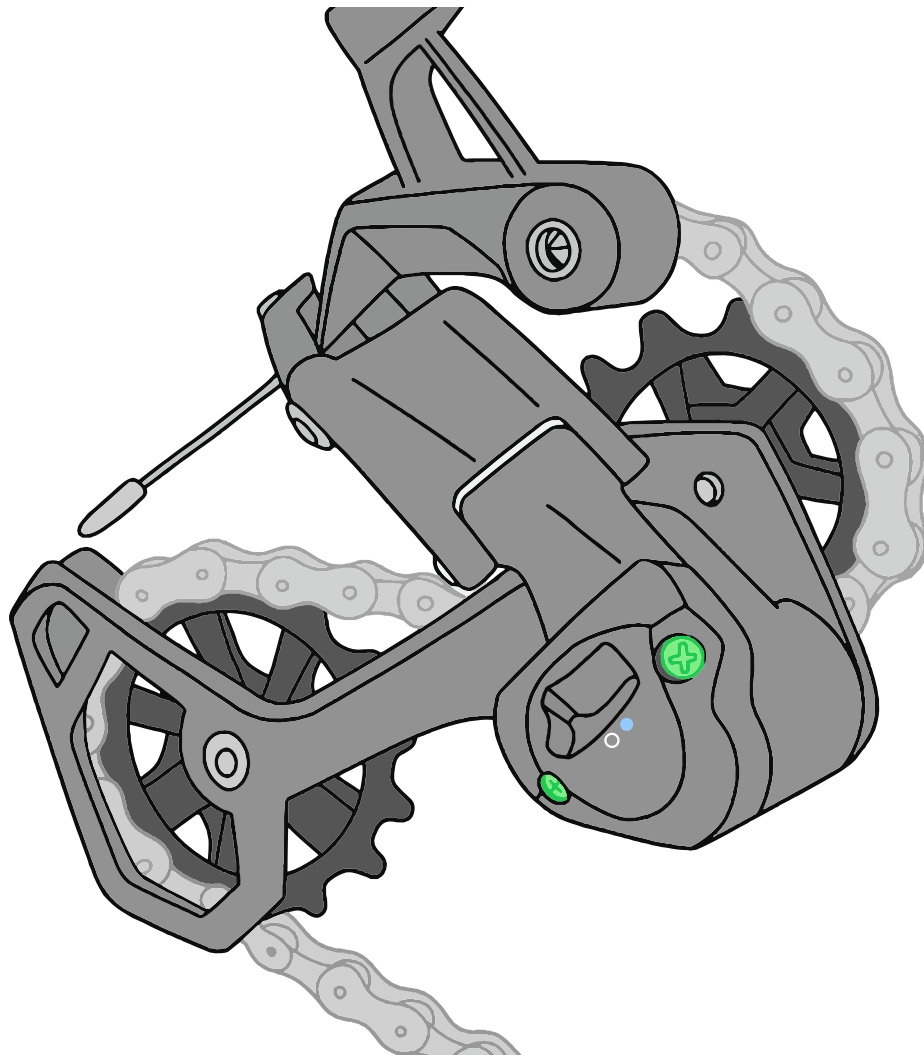

# Adjusting Clutch Tension

Part II

Use a **T15 torx wrench** to tighten **the clutch assembly bolt** a quarter turn at a time.

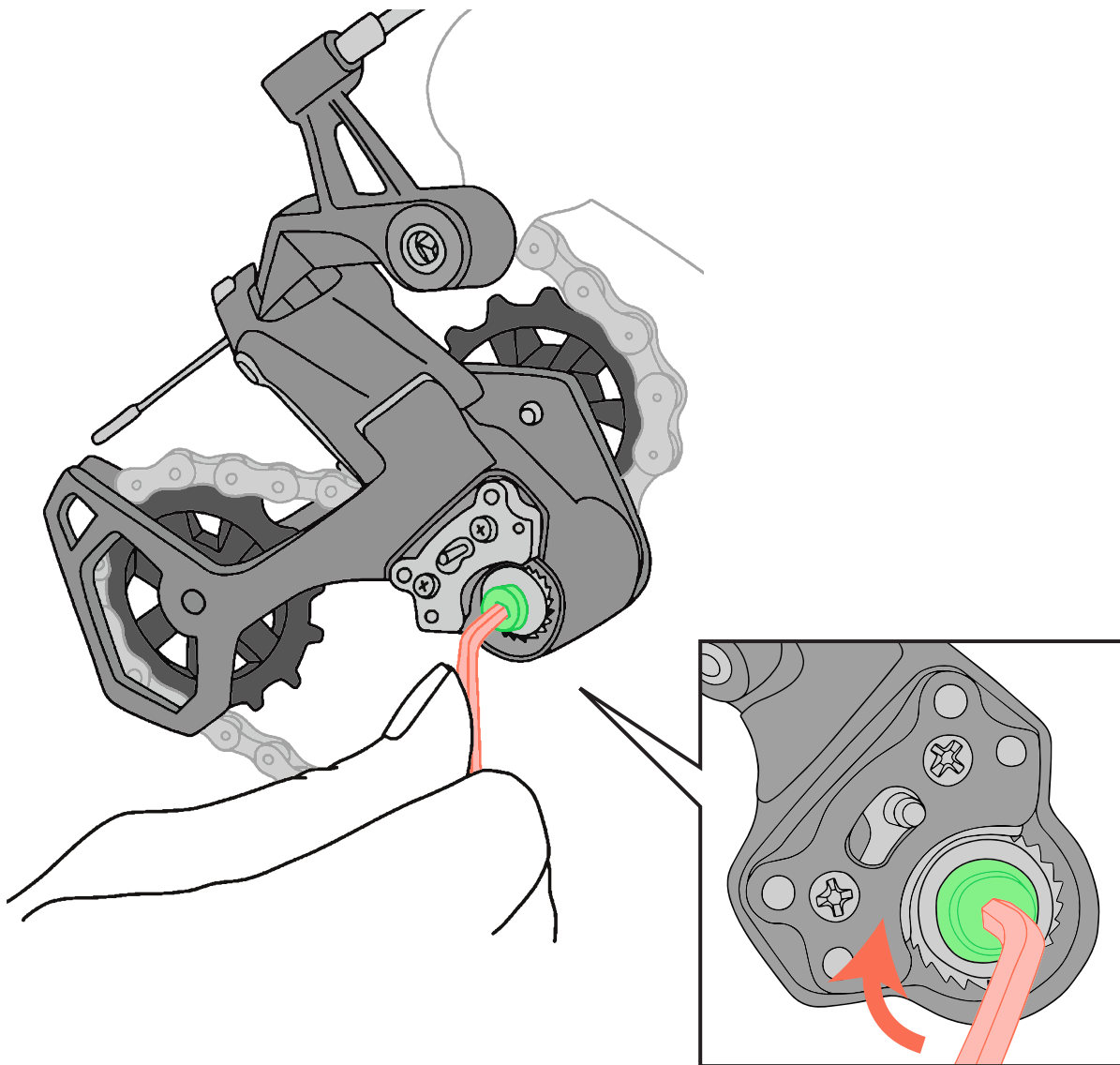

# Adjusting Clutch Tension

Part III

**Push** the derailleur cage forward after each adjustment to test clutch strength.

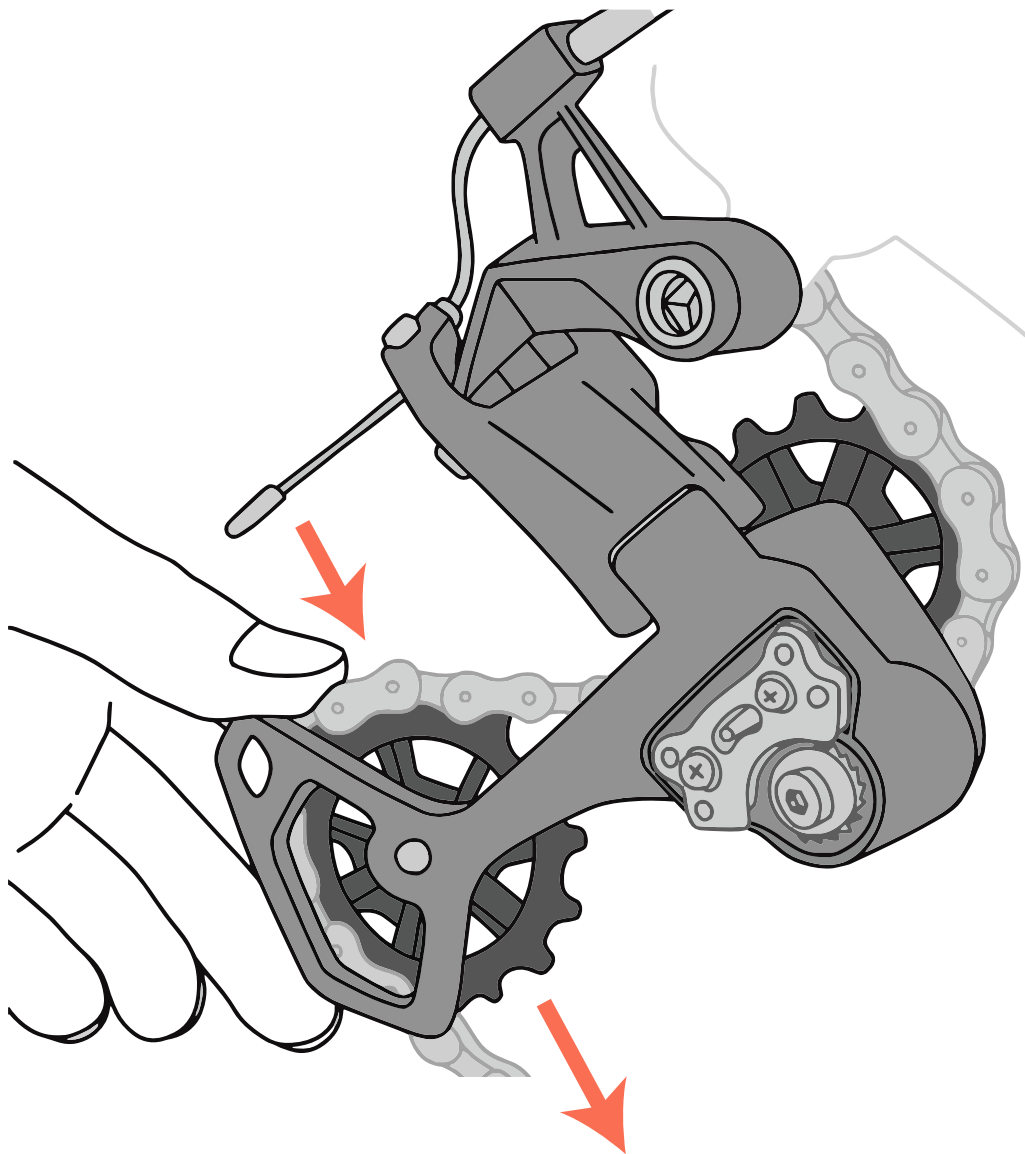

# Adjusting Clutch Tension

Part IV

Replace **the clutch cover** and torque **the screws** to  $< 2\text{nm}$ .

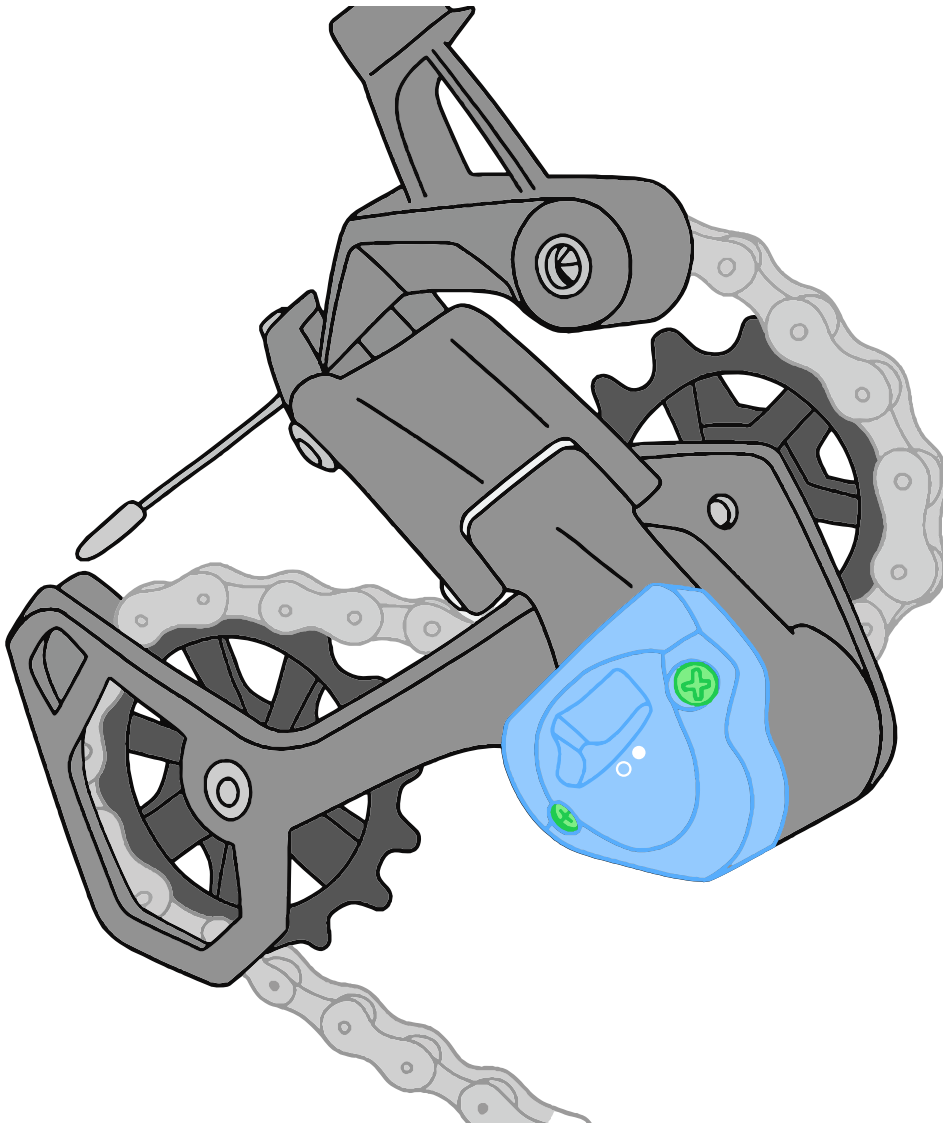

# microSHIFT

---

[www.microSHIFT.com](http://www.microSHIFT.com)

**International**  
[service@microSHIFT.com](mailto:service@microSHIFT.com)

**North America**  
[service@microSHIFT.com](mailto:service@microSHIFT.com)