

Standard Preparation 2000 mm Solid Wall Shelf with Brackets

ITEM # _____

MODEL # _____

NAME # _____

SIS # _____

AIA # _____

**132828 (WSS204N)**Solid wall shelf with brackets,
2000mm

Short Form Specification

Item No. _____

Made from 304 AISI stainless steel, 1mm in thickness. Upturned edges. Integral radiused rear upstand, h=30mm. Wall brackets allow the shelf to be positioned at different heights.

Main Features

- Smooth surfaces, rounded corners, absence of edges and rear upstand facilitate cleaning operations.
- Sturdiness, stability and reliability of table accurately tested.

Construction

- Made entirely in 304 AISI stainless steel, 10/10 in thickness; with a Scotch Brite finish.
- Upturned edges, 50 mm high, to guarantee operator safety.
- Incorporates a rear upstand to avoid spillage between wall and shelf.
- 100 mm upstand with 10 mm radiused corner and 13 mm deep, designed to be used against a wall.

APPROVAL: _____

Standard Preparation 2000 mm Solid Wall Shelf with Brackets

Key Information:

**External dimensions,
Width:**

132828 (WSS204N) 2000 mm

**External dimensions,
Depth:**

400 mm

**External dimensions,
Height:**

30 mm

**Upstand Dimensions,
Height:**

23 mm

**Upstand Dimensions,
Depth:**

2 mm

**Upstand Dimensions,
Radius:**

R=10

Net weight:

10 kg

Front

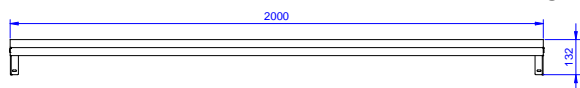

Side

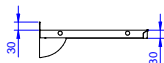

Top

